

LOC		QTY
A	PYLON	1
B	SCRIPT SIGN 5'-0" x 11'-9"	3
C	WALL CABINET 5'-11" x 5'-11"	1
D	STOP / DO NOT ENTER	1
E	STOP	4
F	DRIVE THRU	1
G	DRIVE THRU RIGHT ARROW	1
H	ADA	1
I	ADA WITH VAN ACCESS	1
J	FLAG POLE (50')	1
K		
L		
M		
N		
O		
P		
Q		
R		



5198 North Lake Drive
Lake City, GA 30260
404-361-3800 fax 404-361-7038
website - www.claytonsigns.com

S and R	ALL ELECTRICAL SIGNS ARE 120 VOLTS UNLESS OTHERWISE INDICATED	DRAWN BY BRANDON GUEST	STORE NUMBER 534	STORE ADDRESS Chick-Fil-A 115 Cherokee Place Cartersville, GA 30127 Cherokee Place	THIS DRAWING IS AN ORIGINAL, UNPUBLISHED DESIGN CREATED BY CLAYTON SIGNS, INC. IT IS NOT TO BE REPRODUCED, CHANGED, OR EXHIBITED TO ANYONE OUTSIDE OF YOUR COMPANY IN WHOLE OR IN PART WITHOUT © 2005 ALL RIGHTS RESERVED	
		ACCOUNT REP. BRANDON GUEST				
		DRAWING DATE 11-22-17				

SPECIFICATIONS

CABINET
ALUMINUM CABINET HAS STEEL FRAME WITH .080 ALUMINUM CLADDING, RETAINERS AND FILLER.

CHICK-FIL-A ICON
ACRYLIC FACES DECORATED WITH TRANSLUCENT VINYL FILM ON SURFACE OF ACRYLIC. FACES ARE BACKLIT BY HIGH OUTPUT FLUORESCENT LAMPS SPACED EVENLY ON 8" CENTERS.

READER BOARD
ALUMINUM CONSTRUCTION CABINET WITH ACRYLIC FACES BACKLIT BY HIGH OUTPUT FLUORESCENT LAMPS SPACED EVENLY ON 8" CENTERS. TRACK ACCOMMODATES WAGNER ZIP LETTERS.



FACES
230-53 CARDINAL RED
TRANSLUCENT VINYL FILM





7328 WHITE ACRYLIC



ALUMINUM SURFACES
PAINTED DARK BRONZE
TO MATCH BUILDING

SEE ENGINEER STAMPED DRAWING
FOR FOUNDATION DETAILS

**FLOURESCENT CABINET**

**WET LOCATION**

LIGHTING 18/HO/LAMPS POWER SUPPLY EESB ELECTRONIC BALLAST	CONNECT THE AC LINE TO THE BLACK (LINE) AND WHITE (NEUTRAL) INPUT WIRES OF THE POWER SUPPLY USING 18-14 AWG TWIST ON WIRE CONNECTORS. GROUND POWER SUPPLY GREEN WIRE TO GROUNDING SCREW.	WHITE BLACK YEL/GRN		BLUE RED
---	--	---------------------------	---	-------------

THIS SIGN IS ITENDED TO BE INSTALLED IN ACCORDANCE WITH REQUIREMENTS OF ARTICLE 600 OF THE NATIONAL ELECTRICAL CODE AND/OR APPLICABLE LOCAL CODES. THIS INCLUDES PROPER GROUNDING & BONDING OF THE SIGN.



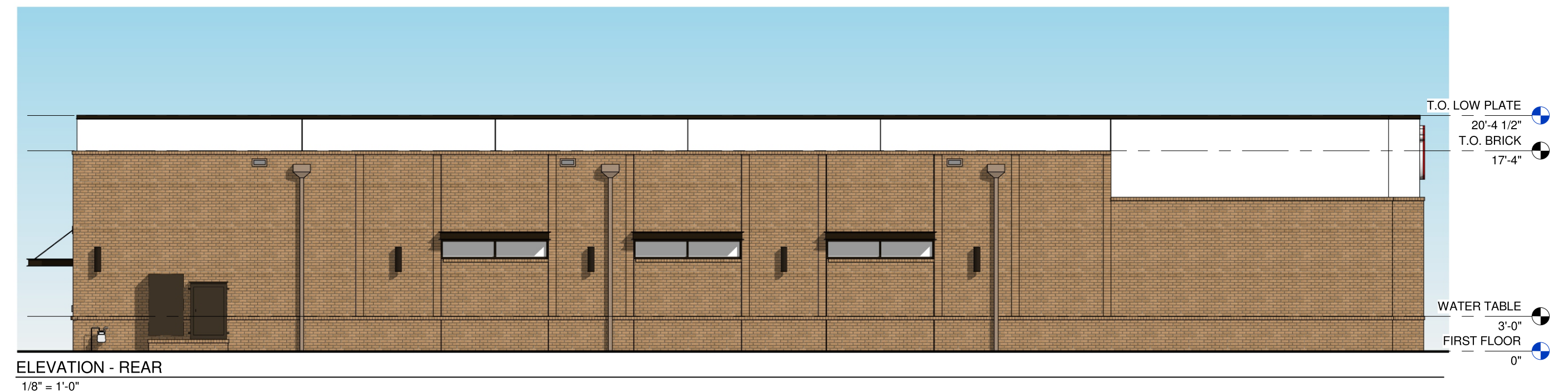

5198 North Lake Drive
Lake City, GA 30260
404-361-3800 fax 404-361-7038
website - www.claytonsigns.com

ALL ELECTRICAL
SIGNS ARE
120 VOLTS
UNLESS
OTHERWISE INDICATED

DRAWN BY BRANDON GUEST
ACCOUNT REP. BRANDON GUEST
DRAWING DATE 11-22-17

STORE NUMBER
534

STORE ADDRESS
Chick-Fil-A
115 Cherokee Place
Cartersville, GA 30127
Cherokee Place

THIS DRAWING IS AN ORIGINAL, UNPUBLISHED
DESIGN CREATED BY CLAYTON SIGNS, INC. IT
IS NOT TO BE REPRODUCED, CHANGED, OR
EXHIBITED TO ANYONE OUTSIDE OF YOUR
COMPANY IN WHOLE OR IN PART WITHOUT
© 2005 ALL RIGHTS RESERVED

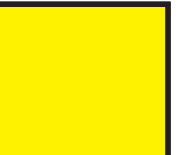



ELEVATION - DRIVE-THRU
1/8" = 1'-0"



ELEVATION - SIDE
1/8" = 1'-0"



5198 North Lake Drive
Lake City, GA 30260
404-361-3800 fax 404-361-7038
website - www.claytonsigns.com

S and R		ALL ELECTRICAL SIGNS ARE 120 VOLTS UNLESS OTHERWISE INDICATED	DRAWN BY BRANDON GUEST	STORE NUMBER 534	STORE ADDRESS Chick-Fil-A 115 Cherokee Place Cartersville, GA 30127 Cherokee Place	THIS DRAWING IS AN ORIGINAL, UNPUBLISHED DESIGN CREATED BY CLAYTON SIGNS, INC. IT IS NOT TO BE REPRODUCED, CHANGED, OR EXHIBITED TO ANYONE OUTSIDE OF YOUR COMPANY IN WHOLE OR IN PART WITHOUT © 2005 ALL RIGHTS RESERVED	
			ACCOUNT REP. BRANDON GUEST				
			DRAWING DATE 11-22-17				

SPECIFICATIONS

CHICK-FIL-A SCRIPT LETTERS
LETTERS ARE LED-ILLUMINATED
CHANNEL LETTERS MOUNTED
ON ALUMINUM SURFACE OF BUILDING
WITH TRANSFORMERS REMOTELY
LOCATED BEHIND THE WALL IN
UL APPROVED TRANSFORMER BOXES.
FACES ARE 3/16" ACRYLIC
RETURNS ARE .063 ALUMINUM
BACKS ARE .080 ALUMINUM
ALL RETURNS ARE ARC-WELDED TO
LETTER BACKS

CHANNEL LETTER FACES
2793 RED ACRYLIC
TRIMCAP RETAINER-
1" RED JEWELITE TRIMCAP

ALUMINUM RETURNS
PAINTED TO MATCH
SHERWIN WILLIAMS
SW6108 LATTE

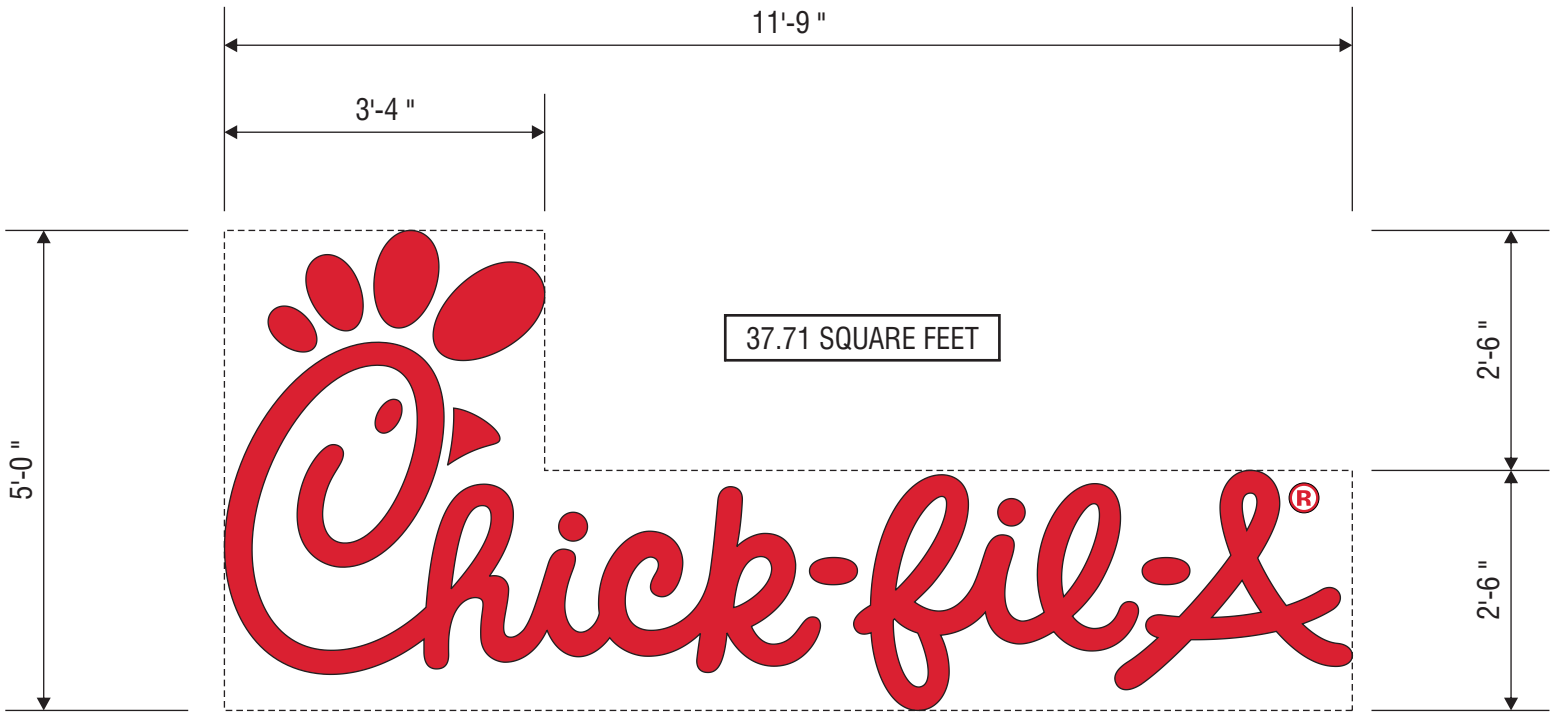

ELEVATION

SCALE - 1/2" = 1'- 0"

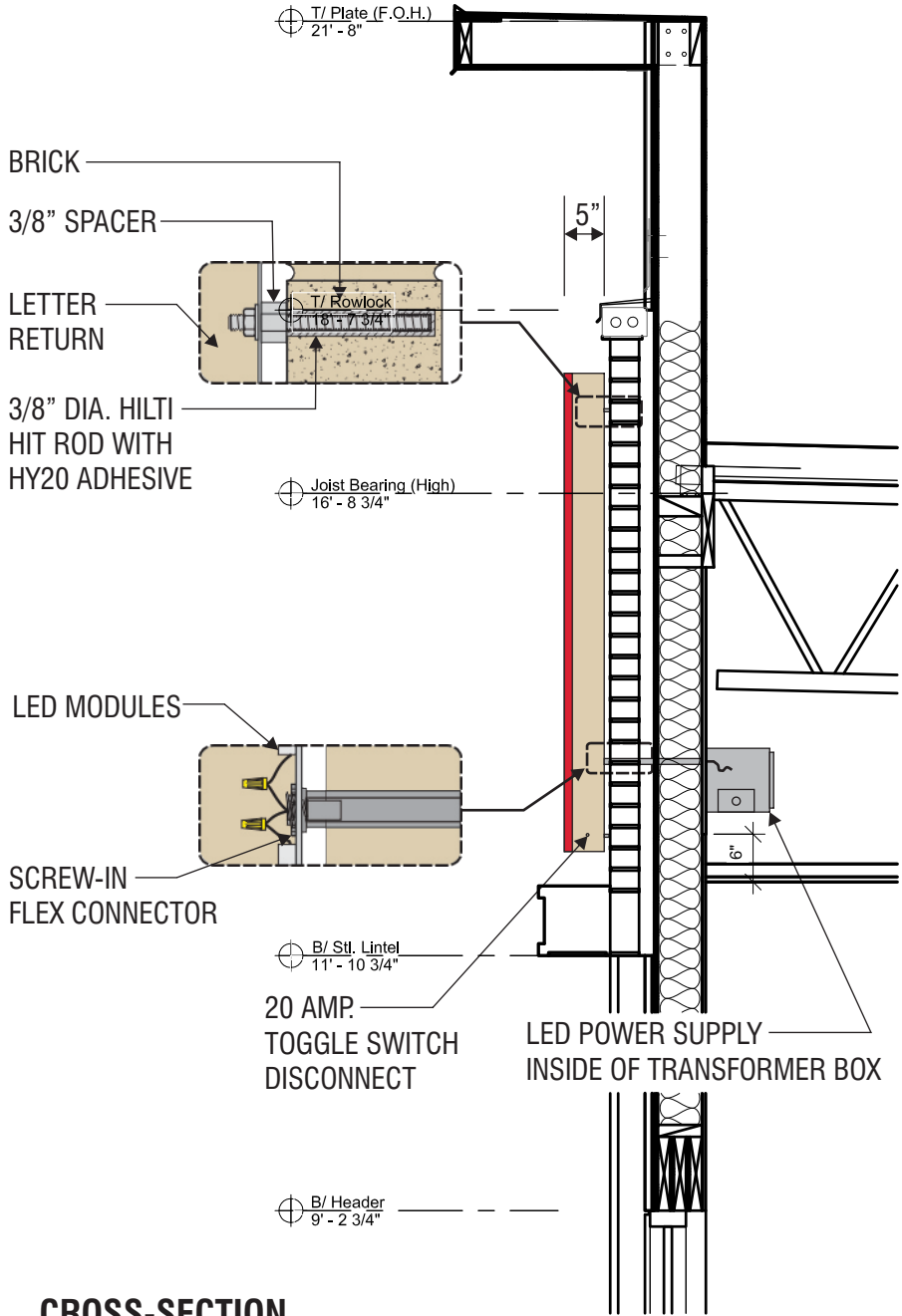

CROSS-SECTION

SCALE - 1/2" = 1'- 0"

CLAYTON
Signs

UL LISTED

CHANNEL LETTERS (RED ILLUMINATION)

WET LOCATION

LED's
JTSL5016R-0.4 RED LED
POWER SUPPLY
BL-120-12-60 POWER SUPPLY

CONNECT THE AC LINE TO THE BLACK (LINE) AND WHITE (NEUTRAL) INPUT WIRES OF THE POWER SUPPLY USING 18-14 AWG TWIST ON WIRE CONNECTORS. GROUND POWER SUPPLY GREEN WIRE TO GROUNDING SCREW. REPLACE JUNCTION BOX COVER.

Green with yellow stripe (ground)
White (neutral)
Black (line)
AC line

THIS SIGN IS INTENDED TO BE INSTALLED IN ACCORDANCE WITH REQUIREMENTS OF ARTICLE 600 OF THE NATIONAL ELECTRICAL CODE AND/OR APPLICABLE LOCAL CODES. THIS INCLUDES PROPER GROUNDING & BONDING OF THE SIGN.



5198 North Lake Drive
Lake City, GA 30260
404-361-3800 fax 404-361-7038
website - www.claytonsigns.com

S and R

ALL ELECTRICAL
SIGNS ARE
120 VOLTS
UNLESS
OTHERWISE INDICATED

DRAWN BY BRANDON GUEST
ACCOUNT REP. BRANDON GUEST
DRAWING DATE 11-22-17

STORE NUMBER
534

STORE ADDRESS
Chick-Fil-A
115 Cherokee Place
Cartersville, GA 30127
Cherokee Place

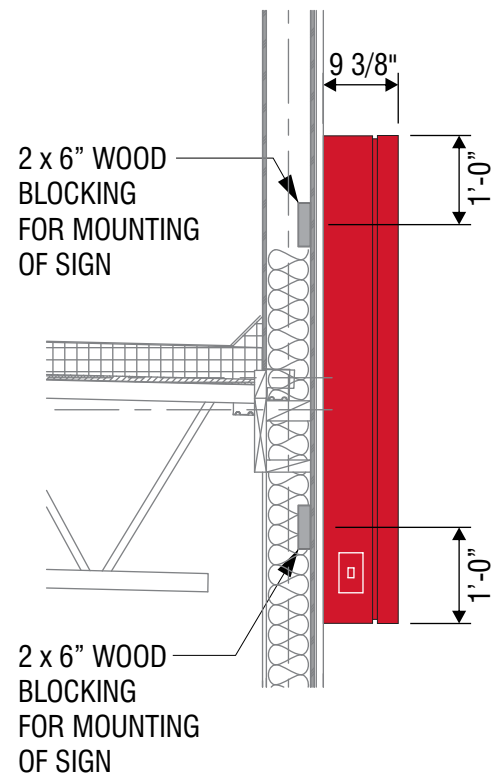

THIS DRAWING IS AN ORIGINAL, UNPUBLISHED
DESIGN CREATED BY CLAYTON SIGNS, INC. IT
IS NOT TO BE REPRODUCED, CHANGED, OR
EXHIBITED TO ANYONE OUTSIDE OF YOUR
COMPANY IN WHOLE OR IN PART WITHOUT
© 2005 ALL RIGHTS RESERVED

B



END VIEW

SCALE - 1/2" = 1'- 0"



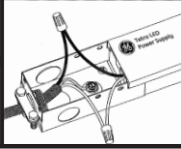

SINGLE FACED CABINET

LED's GEWHSSPS3 - 71K - SINGLED SID
POWER SUPPLY
GEPS12 - 12V POWER SUPPLY

WET LOCATION

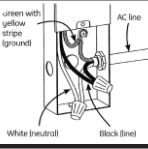
CONNECT THE AC LINE TO THE BLACK (LINE) AND WHITE (NEUTRAL) INPUT WIRES OF THE POWER SUPPLY USING 18-14 AWG TWIST ON WIRE CONNECTORS. GROUND POWER SUPPLY GREEN WIRE TO GROUNDING SCREW. REPLACE JUNCTION BOX COVER.

Green with yellow stripe (ground)
White (neutral)
Black (line)
AC line

THIS SIGN IS ITENDED TO BE INSTALLED IN ACCORDANCE WITH REQUIREMENTS OF ARTICLE 600 OF THE NATIONAL ELECTRICAL CODE AND/OR APPLICABLE LOCAL CODES. THIS INCLUDES PROPER GROUNDING & BONDING OF THE SIGN.

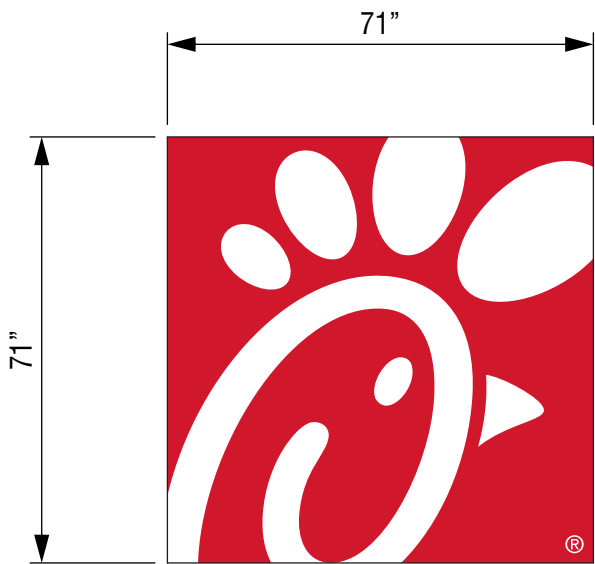

ELEVATION

SCALE - 3/8" = 1'- 0"

35.00 SQUARE FEET

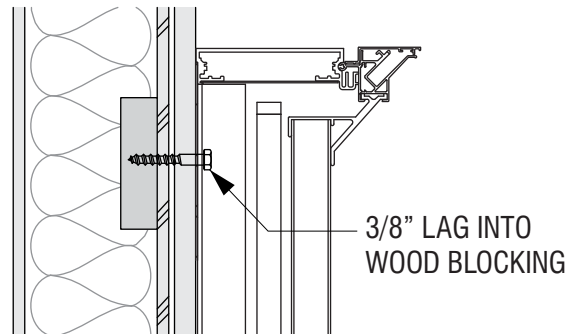

SECTION B-B

NOT TO SCALE

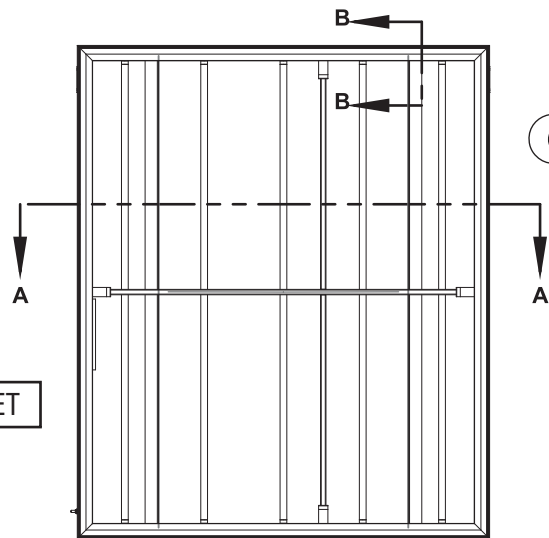

BRACE SUPPORT DETAIL

NOT TO SCALE

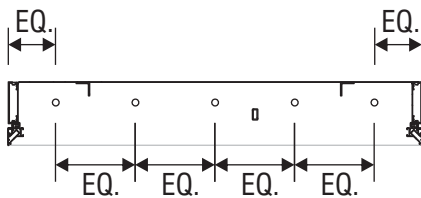

SECTION A-A

SCALE - 1/2" = 1'- 0"

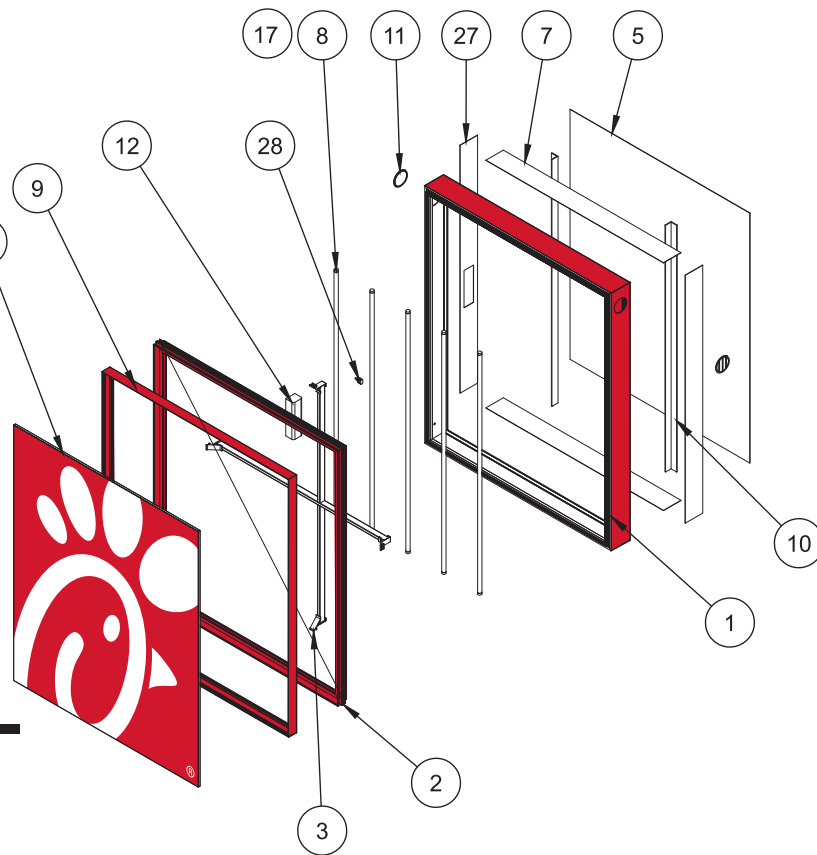

ITEM NO.	DESCRIPTION	QTY.
1	SIGNCOMP #2025 SINGLE FACE BODY CABINET	4
2	SIGNCOMP #2085 ALUM TENTION FRAME RETAINER	4
3	SIGNCOMP #5350 ALUM FRAME BRACE	4
4	SIGNCOMP #2175 ALUM FRAME SUPPORT TUBE	4
5	.080 ALUM BACK	1
6	ARLON CAST FLEX SUBSTRATE	1
7	.063 ALUM RACEWAY COVERS	3
8	F72T8/CW/841/H O/RDC VOLTARC TRILIGHT MAX LAMPS	5
9	SIGNCOMP #2095 ALUM TENTION FRAME COVER	4
10	2X 2X 3/16 ALUM MOUNTING ANGLE	2
11	4" DIA VENT COVER	2
12	EESB832-16L @ 3.0AMPS - 120V ELECTRONIC BALLAST	1
13	SIGNCOMP #5312 ALUM CORNER ANGLE	4
14	SIGNCOMP #5210 ALUM CORNER KEY	4
15	SIGNCOMP #5360 FACE RETENTION CLIPS AT 5"oc	A/R
16	SIGNCOMP ALUM RETAINER CORNER ANGLE	4
17	KULKA 583-GDF SPRINGLOADED LAMP SOCKET	5
18	KULKA 582-GDF SNAP-IN LAMP SOCKET	5
19	1/2" DIA LIQUID TIGHT CONDUIT CONNECTOR	A/R
20	1/2" DIA LIQUID TIGHT FLEXIBLE CONDUIT	A/R
21	SIGNCOMP #5170 RETAINER HINGE SCREWS (18" oc)	A/R
22	SIGNCOMP #5180 RETAINER CLOSURE SCREWS (18"oc)	A/R
23	SIGNCOMP #5195 COVER SCREWS (24"oc)	A/R
24	SIGNCOMP FRAME BRACE SCREWS	A/R
25	#8 SHEET METAL SCREWS	A/R
26	FIRST SURFACE APPLIED VINYL (ARLON 230-53 CARDINAL RED)	1
27	.063 ALUM RACWAY COVER WITH BALLAST HOLE	1
28	20 AMP TOGGLE SWITCH	1



5198 North Lake Drive
Lake City, GA 30260
404-361-3800 fax 404-361-7038
website - www.claytonsigns.com

S and R

ALL ELECTRICAL
SIGNS ARE
120 VOLTS
UNLESS
OTHERWISE INDICATED

DRAWN BY BRANDON GUEST
ACCOUNT REP. BRANDON GUEST
DRAWING DATE 11-22-17

STORE NUMBER
534

STORE ADDRESS
Chick-Fil-A
115 Cherokee Place
Cartersville, GA 30127
Cherokee Place

THIS DRAWING IS AN ORIGINAL, UNPUBLISHED
DESIGN CREATED BY CLAYTON SIGNS, INC. IT
IS NOT TO BE REPRODUCED, CHANGED, OR
EXHIBITED TO ANYONE OUTSIDE OF YOUR
COMPANY IN WHOLE OR IN PART WITHOUT

© 2005 ALL RIGHTS RESERVED



SPECIFICATIONS

SIGN PANELS

PANELS ARE .080 ALUMINUM
WITH REFLECTIVE BACKGROUND
AND GRAPHICS.

SIGN POSTS

POSTS ARE 2" x 2" SQUARE
ALUMINUM TUBING CAPPED ON TOP



SIGN PANEL
RED REFLECTIVE



SIGN PANEL
WHITE REFLECTIVE



BACK OF SIGN PANEL AND POST
DARK BRONZE

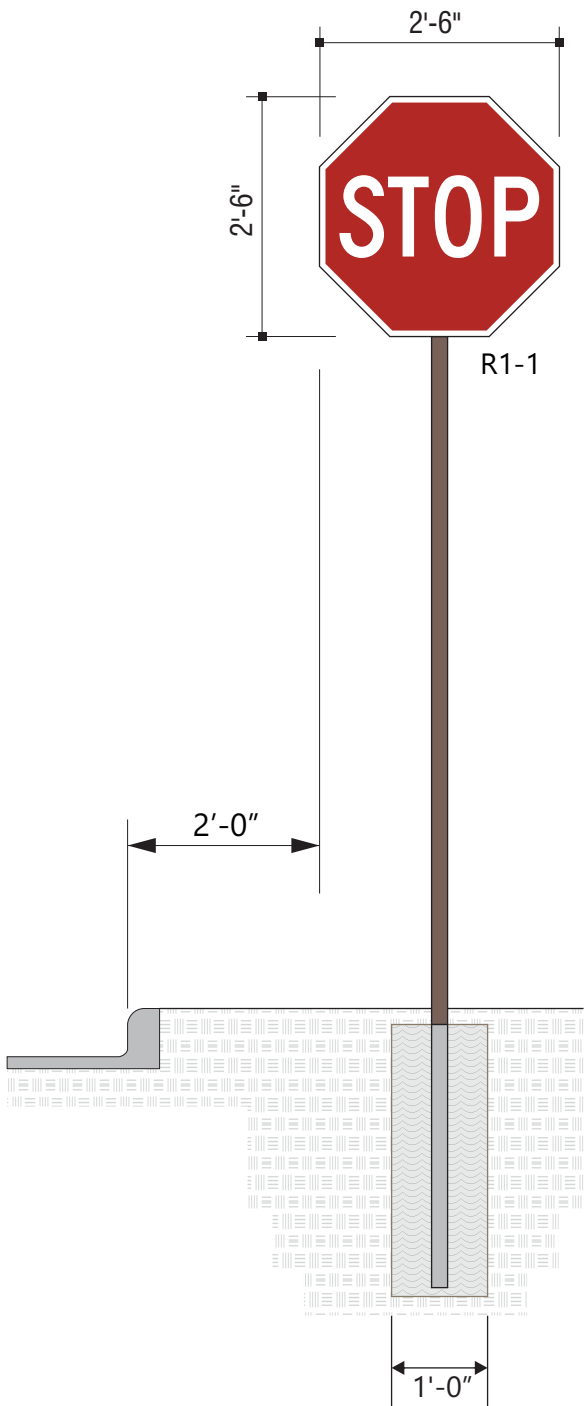

ELEVATION

SCALE - 1/2" = 1'- 0"

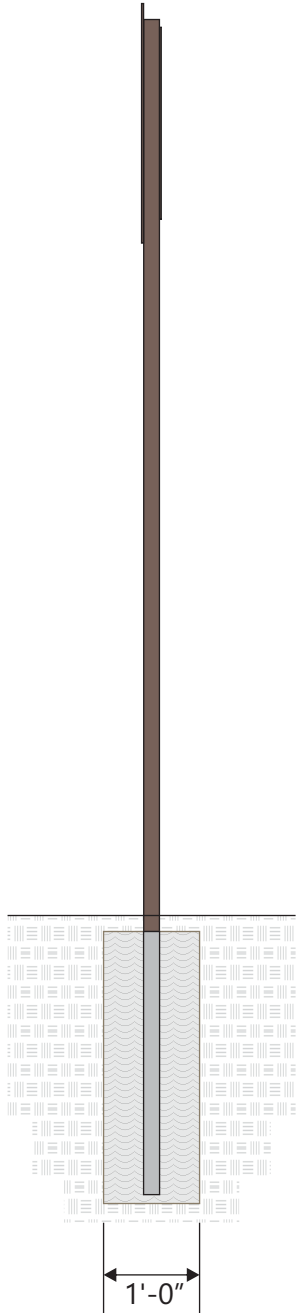

END VIEW

SCALE - 1/2" = 1'- 0"



SIDE B

7'-0"
BOTTOM OF PANEL

0'-0 "
TOP OF CURB

-3'-0 "
BOTTOM OF FOUNDATION

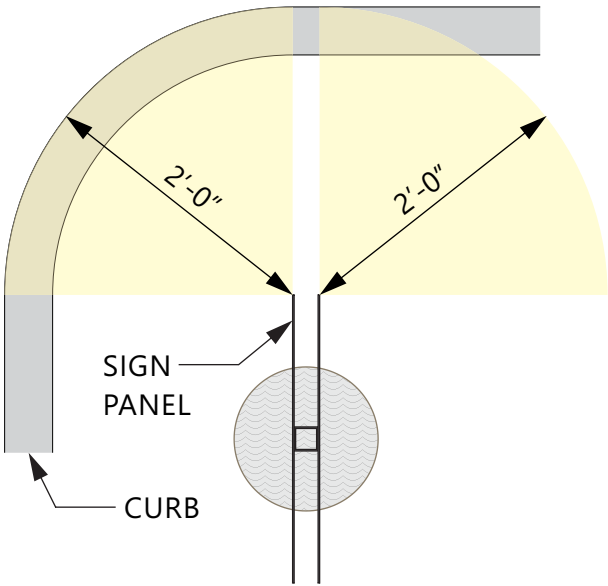

PLAN VIEW

SCALE - 3/4" = 1'- 0"



5198 North Lake Drive
Lake City, GA 30260
404-361-3800 fax 404-361-7038
website - www.claytonsigns.com

ALL ELECTRICAL
SIGNS ARE
120 VOLTS
UNLESS
OTHERWISE INDICATED

DRAWN BY BRANDON GUEST
ACCOUNT REP. BRANDON GUEST
DRAWING DATE 11-22-17

STORE NUMBER
534

STORE ADDRESS
Chick-Fil-A
115 Cherokee Place
Cartersville, GA 30127
Cherokee Place

THIS DRAWING IS AN ORIGINAL, UNPUBLISHED
DESIGN CREATED BY CLAYTON SIGNS, INC. IT
IS NOT TO BE REPRODUCED, CHANGED, OR
EXHIBITED TO ANYONE OUTSIDE OF YOUR
COMPANY IN WHOLE OR IN PART WITHOUT

© 2005 ALL RIGHTS RESERVED

D

SPECIFICATIONS

SIGN PANELS

PANELS ARE .080 ALUMINUM
WITH REFLECTIVE BACKGROUND
AND GRAPHICS.

SIGN POSTS

POSTS ARE 2" x 2" SQUARE
ALUMINUM TUBING CAPPED ON TOP



SIGN PANEL
RED REFLECTIVE



SIGN PANEL
WHITE REFLECTIVE



BACK OF SIGN PANEL AND POST
DARK BRONZE

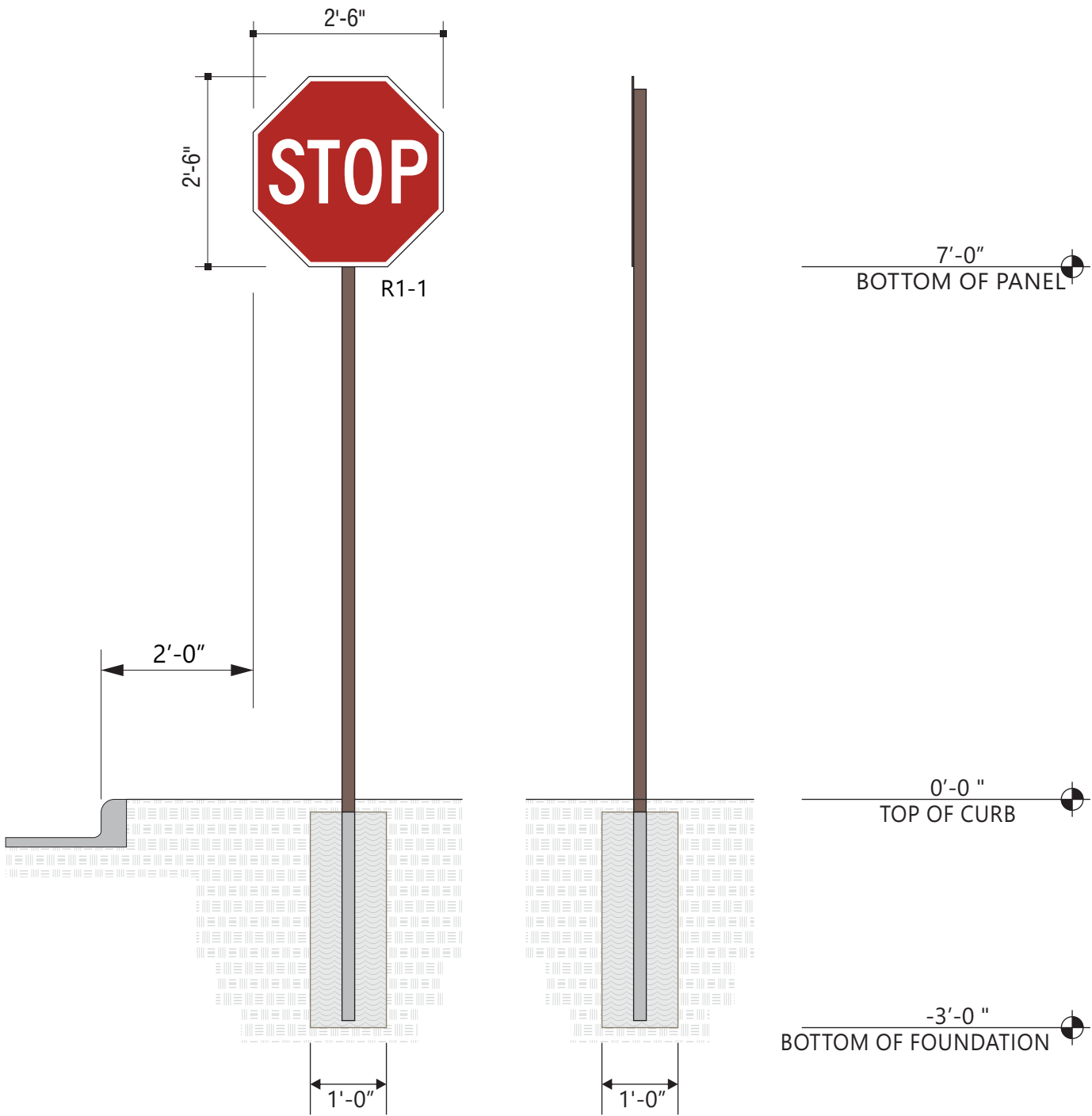

ELEVATION

SCALE - 1/2" = 1'- 0"

END VIEW

SCALE - 1/2" = 1'- 0"

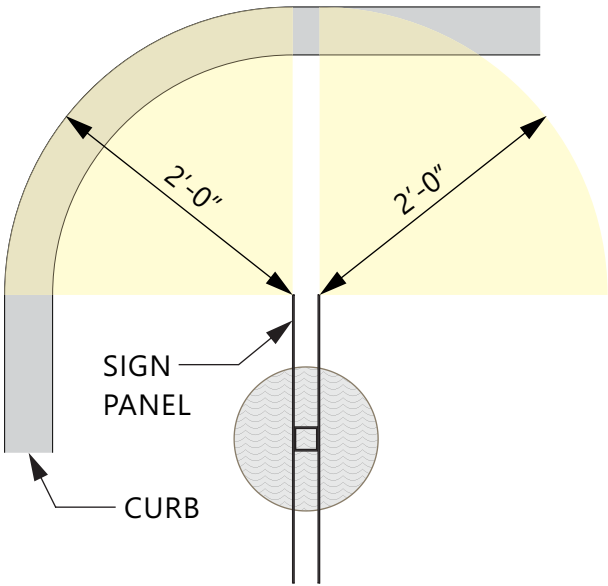

PLAN VIEW

SCALE - 3/4" = 1'- 0"



5198 North Lake Drive
Lake City, GA 30260
404-361-3800 fax 404-361-7038
website - www.claytonsigns.com

ALL ELECTRICAL
SIGNS ARE
120 VOLTS
UNLESS
OTHERWISE INDICATED

DRAWN BY BRANDON GUEST
ACCOUNT REP. BRANDON GUEST
DRAWING DATE 11-22-17

STORE NUMBER
534

STORE ADDRESS
Chick-Fil-A
115 Cherokee Place
Cartersville, GA 30127
Cherokee Place

THIS DRAWING IS AN ORIGINAL, UNPUBLISHED
DESIGN CREATED BY CLAYTON SIGNS, INC. IT
IS NOT TO BE REPRODUCED, CHANGED, OR
EXHIBITED TO ANYONE OUTSIDE OF YOUR
COMPANY IN WHOLE OR IN PART WITHOUT

© 2005 ALL RIGHTS RESERVED

E

SPECIFICATIONS

SIGN PANELS

PANELS ARE .080 ALUMINUM
WITH REFLECTIVE BACKGROUND
AND GRAPHICS.

SIGN POSTS

POSTS ARE 2" x 2" SQUARE
ALUMINUM TUBING CAPPED ON TOP



SIGN PANEL
RED REFLECTIVE



SIGN PANEL
WHITE REFLECTIVE



BACK OF SIGN PANEL AND POST
DARK BRONZE

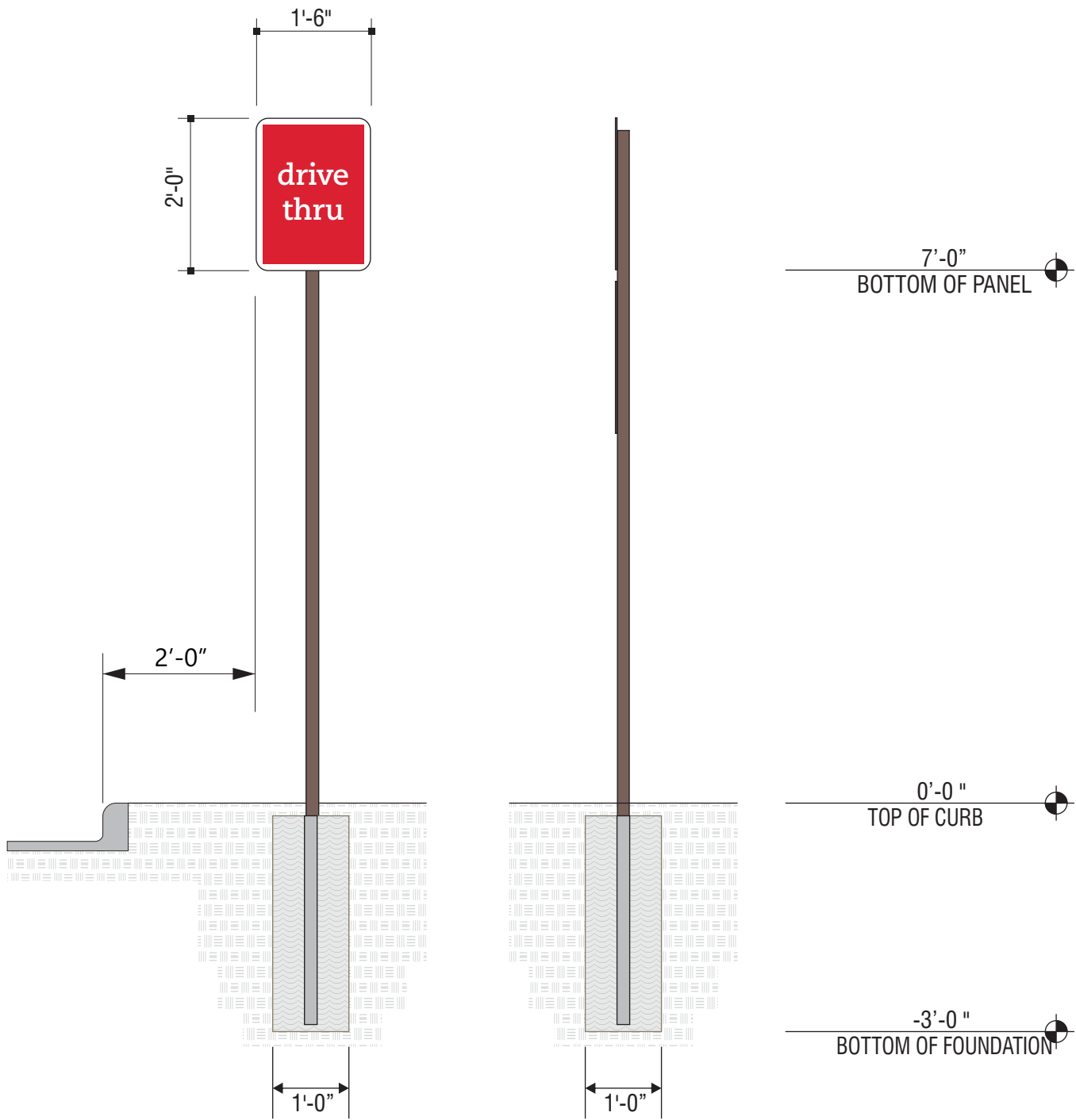

ELEVATION

SCALE - 1/2" = 1'- 0"

END VIEW

SCALE - 1/2" = 1'- 0"

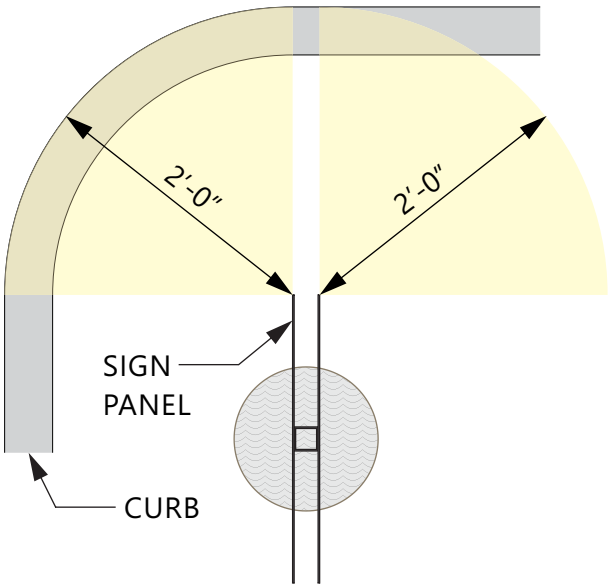

PLAN VIEW

SCALE - 3/4" = 1'- 0"



5198 North Lake Drive
Lake City, GA 30260
404-361-3800 fax 404-361-7038
website - www.claytonsigns.com

ALL ELECTRICAL
SIGNS ARE
120 VOLTS
UNLESS
OTHERWISE INDICATED

DRAWN BY BRANDON GUEST
ACCOUNT REP. BRANDON GUEST
DRAWING DATE 11-22-17

STORE NUMBER
534

STORE ADDRESS
Chick-Fil-A
115 Cherokee Place
Cartersville, GA 30127
Cherokee Place

THIS DRAWING IS AN ORIGINAL, UNPUBLISHED
DESIGN CREATED BY CLAYTON SIGNS, INC. IT
IS NOT TO BE REPRODUCED, CHANGED, OR
EXHIBITED TO ANYONE OUTSIDE OF YOUR
COMPANY IN WHOLE OR IN PART WITHOUT

© 2005 ALL RIGHTS RESERVED

F

SPECIFICATIONS

SIGN PANELS

PANELS ARE .080 ALUMINUM
WITH REFLECTIVE BACKGROUND
AND GRAPHICS.

SIGN POSTS

POSTS ARE 2" x 2" SQUARE
ALUMINUM TUBING CAPPED ON TOP



SIGN PANEL
RED REFLECTIVE



SIGN PANEL
WHITE REFLECTIVE



BACK OF SIGN PANEL AND POST
DARK BRONZE

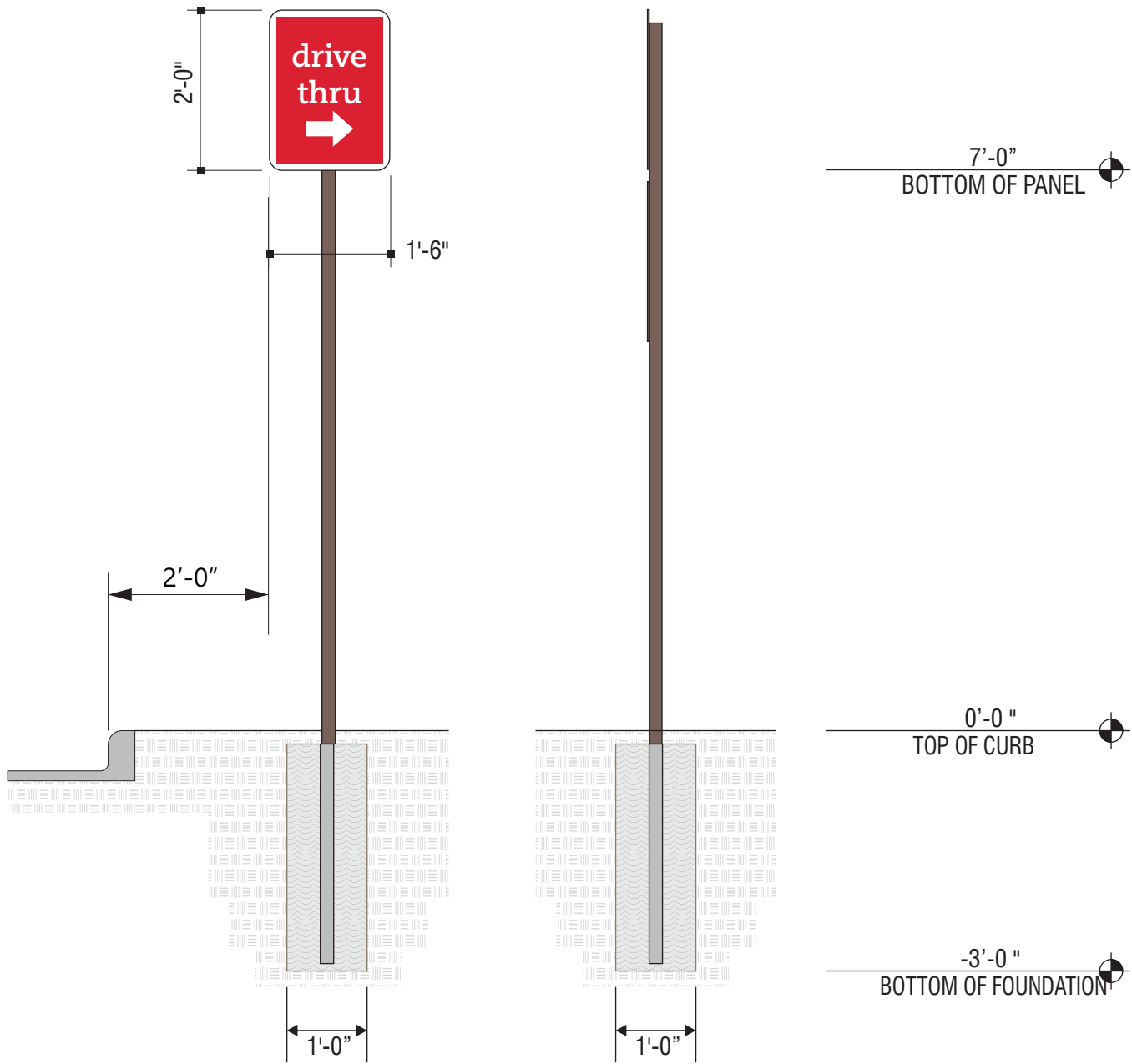

ELEVATION

SCALE - 1/2" = 1'- 0"

END VIEW

SCALE - 1/2" = 1'- 0"

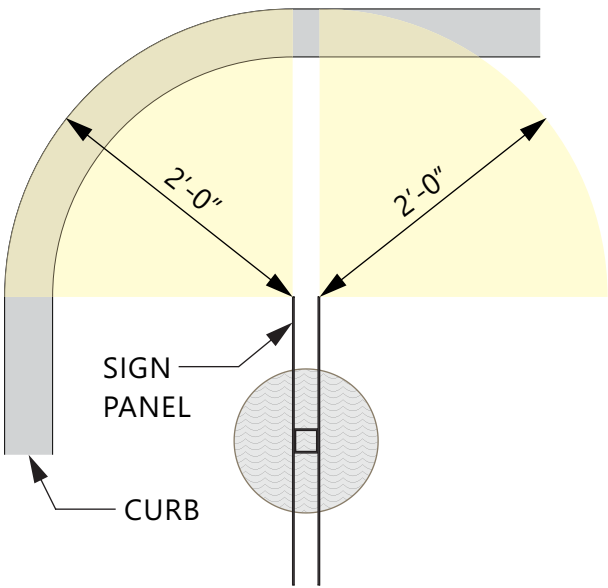

PLAN VIEW

SCALE - 3/4" = 1'- 0"



5198 North Lake Drive
Lake City, GA 30260
404-361-3800 fax 404-361-7038
website - www.claytonsigns.com

ALL ELECTRICAL
SIGNS ARE
120 VOLTS
UNLESS
OTHERWISE INDICATED

DRAWN BY BRANDON GUEST
ACCOUNT REP. BRANDON GUEST
DRAWING DATE 11-22-17

STORE NUMBER
534

STORE ADDRESS
Chick-Fil-A
115 Cherokee Place
Cartersville, GA 30127
Cherokee Place

THIS DRAWING IS AN ORIGINAL, UNPUBLISHED
DESIGN CREATED BY CLAYTON SIGNS, INC. IT
IS NOT TO BE REPRODUCED, CHANGED, OR
EXHIBITED TO ANYONE OUTSIDE OF YOUR
COMPANY IN WHOLE OR IN PART WITHOUT

© 2005 ALL RIGHTS RESERVED



SPECIFICATIONS

SIGN PANELS

PANELS ARE .080 ALUMINUM
WITH REFLECTIVE BACKGROUND
AND GRAPHICS.

SIGN POSTS

POSTS ARE 2" x 2" SQUARE
ALUMINUM TUBING CAPPED ON TOP



BACK OF SIGN PANEL AND POST
DARK BRONZE

NOTE: IF THIS SIGN IS LOCATED ON THE SIDEWALK THEN
IT IS THE RESPONSIBILITY OF THE GENERAL CONTRACTOR
TO INSTALL A PVC SLEEVE INTO THE CONCRETE WHEN THE
SIDEWALK IS POURED PRIOR TO INSTALLATION OF THE SIGN'
BY CLAYTON SIGNS.

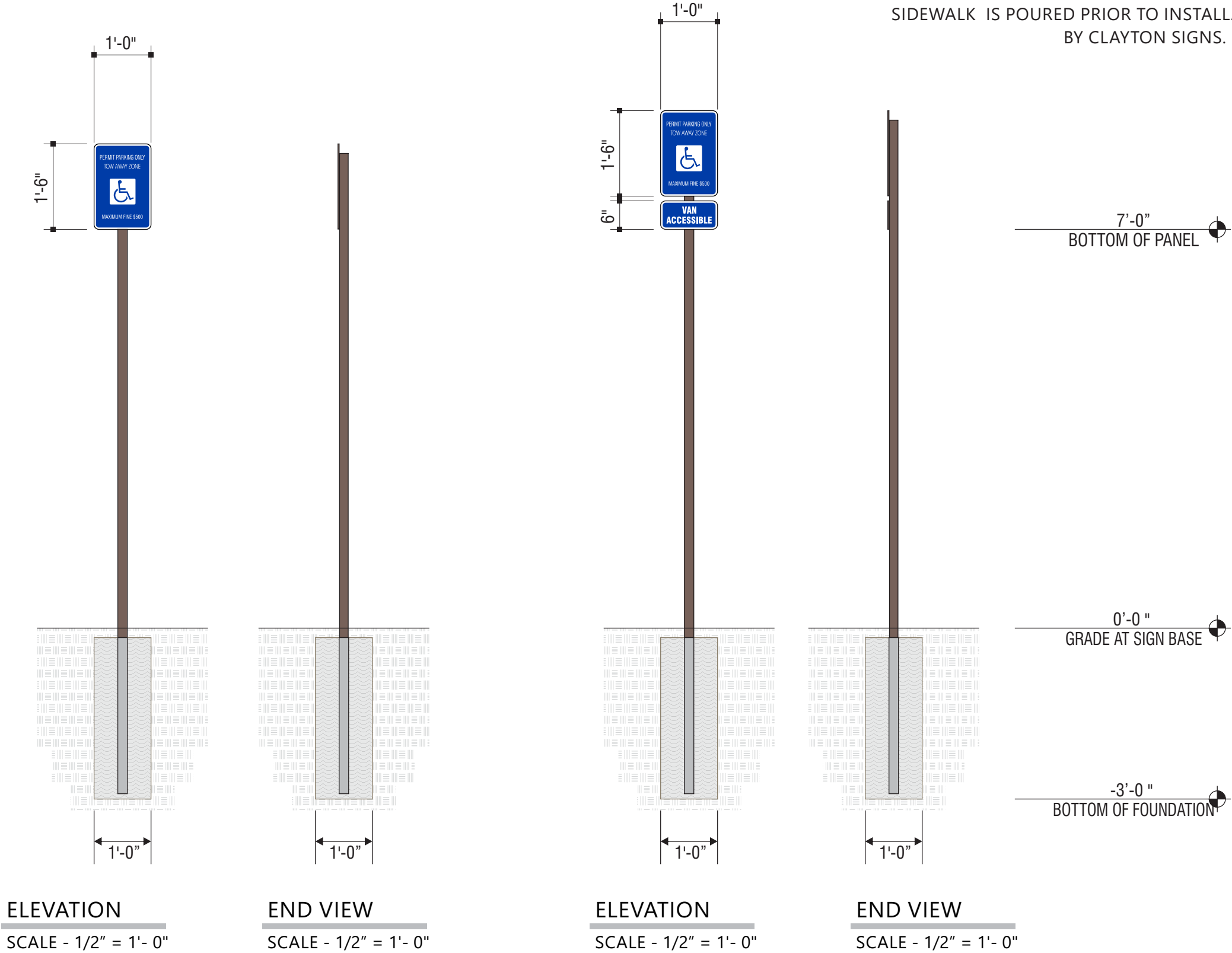

5198 North Lake Drive
Lake City, GA 30260
404-361-3800 fax 404-361-7038
website - www.claytonsigns.com

ALL ELECTRICAL
SIGNS ARE
120 VOLTS
UNLESS
OTHERWISE INDICATED

DRAWN BY BRANDON GUEST
ACCOUNT REP. BRANDON GUEST
DRAWING DATE 11-22-17

STORE NUMBER
534

STORE ADDRESS
Chick-Fil-A
115 Cherokee Place
Cartersville, GA 30127
Cherokee Place

THIS DRAWING IS AN ORIGINAL, UNPUBLISHED
DESIGN CREATED BY CLAYTON SIGNS, INC. IT
IS NOT TO BE REPRODUCED, CHANGED, OR
EXHIBITED TO ANYONE OUTSIDE OF YOUR
COMPANY IN WHOLE OR IN PART WITHOUT
© 2005 ALL RIGHTS RESERVED



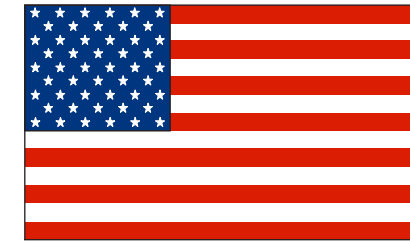
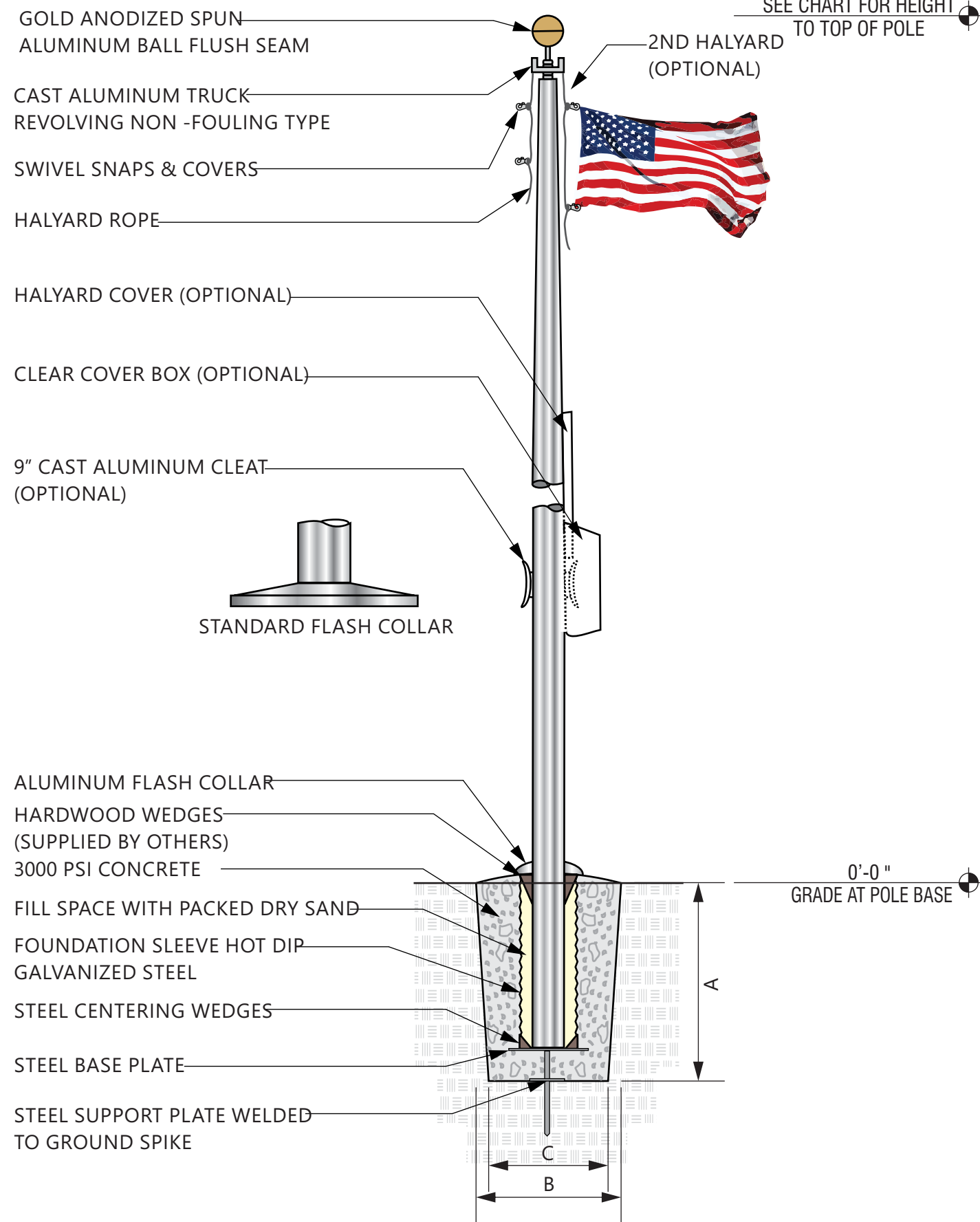

FLAG SIZES

POLE	A	B	MATERIAL
20'	3'0"	5'0"	POLYESTER
25'	4'0"	6'0"	POLYESTER
30'	5'0"	8'0"	POLYESTER
35'	6'0"	10'0"	POLYESTER
40'	8'0"	12'0"	POLYESTER
45'	8'0"	12'0"	POLYESTER
50'	12'0"	18'0"	POLYESTER

FOUNDATION SIZES

HEIGHT	A	B	C
20'	3'6"	30"	24"
25'	3'6"	30"	24"
30'	3'6"	30"	24"
35'	4'0"	36"	30"
40'	4'6"	42"	36"
45'	5'0"	48"	42"
50'	5'6"	48"	42"

GROUND SLEEVE AND CONCRETE INSTALLED
BY THE GENERAL CONTRACTOR
POLE INSTALLED ON PRE-INSTALLED GROUND
SLEEVE BY SIGN CONTRACTOR



5198 North Lake Drive
Lake City, GA 30260
404-361-3800 fax 404-361-7038
website - www.claytonsigns.com

ALL ELECTRICAL
SIGNS ARE
120 VOLTS
UNLESS
OTHERWISE INDICATED

DRAWN BY BRANDON GUEST
ACCOUNT REP. BRANDON GUEST
DRAWING DATE 11-22-17

STORE NUMBER
534

STORE ADDRESS
Chick-Fil-A
115 Cherokee Place
Cartersville, GA 30127
Cherokee Place

THIS DRAWING IS AN ORIGINAL, UNPUBLISHED
DESIGN CREATED BY CLAYTON SIGNS, INC. IT
IS NOT TO BE REPRODUCED, CHANGED, OR
EXHIBITED TO ANYONE OUTSIDE OF YOUR
COMPANY IN WHOLE OR IN PART WITHOUT

© 2005 ALL RIGHTS RESERVED

J

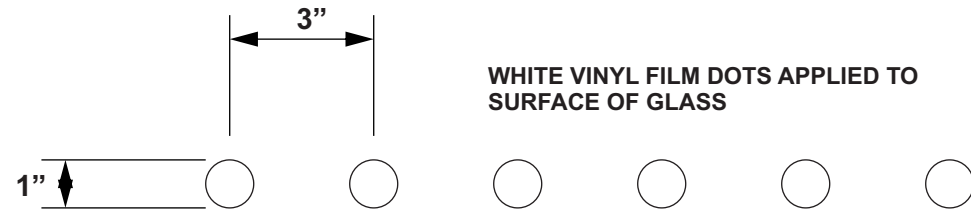

WHITE VINYL FILM DOTS APPLIED TO
SURFACE OF GLASS

ELEVATION

SCALE - 3" = 1'-0"

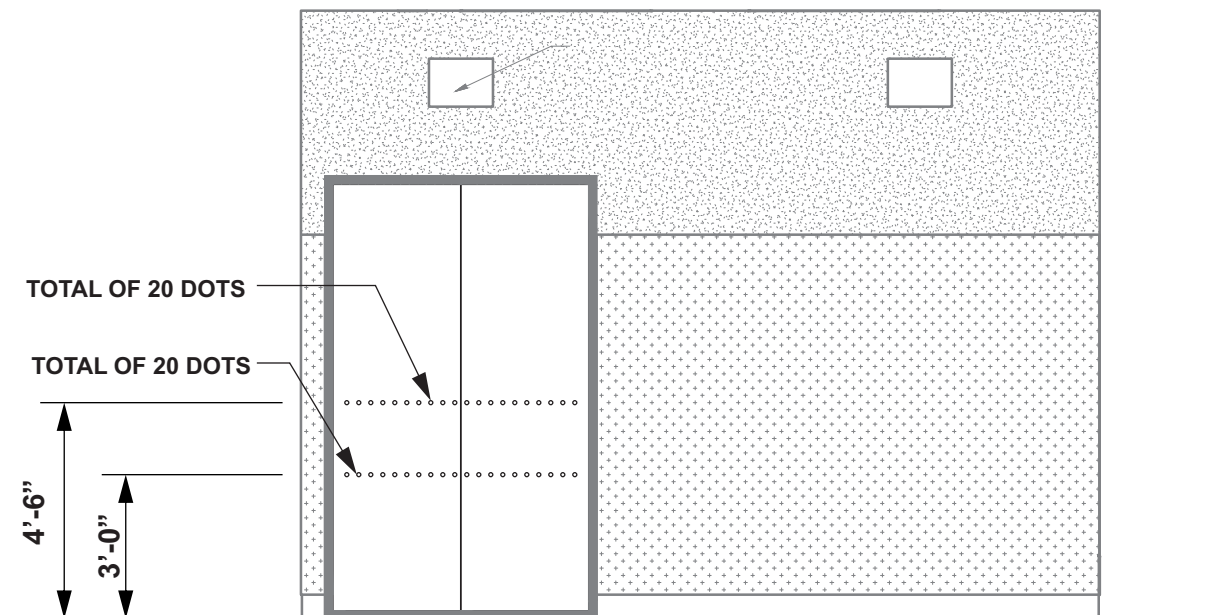
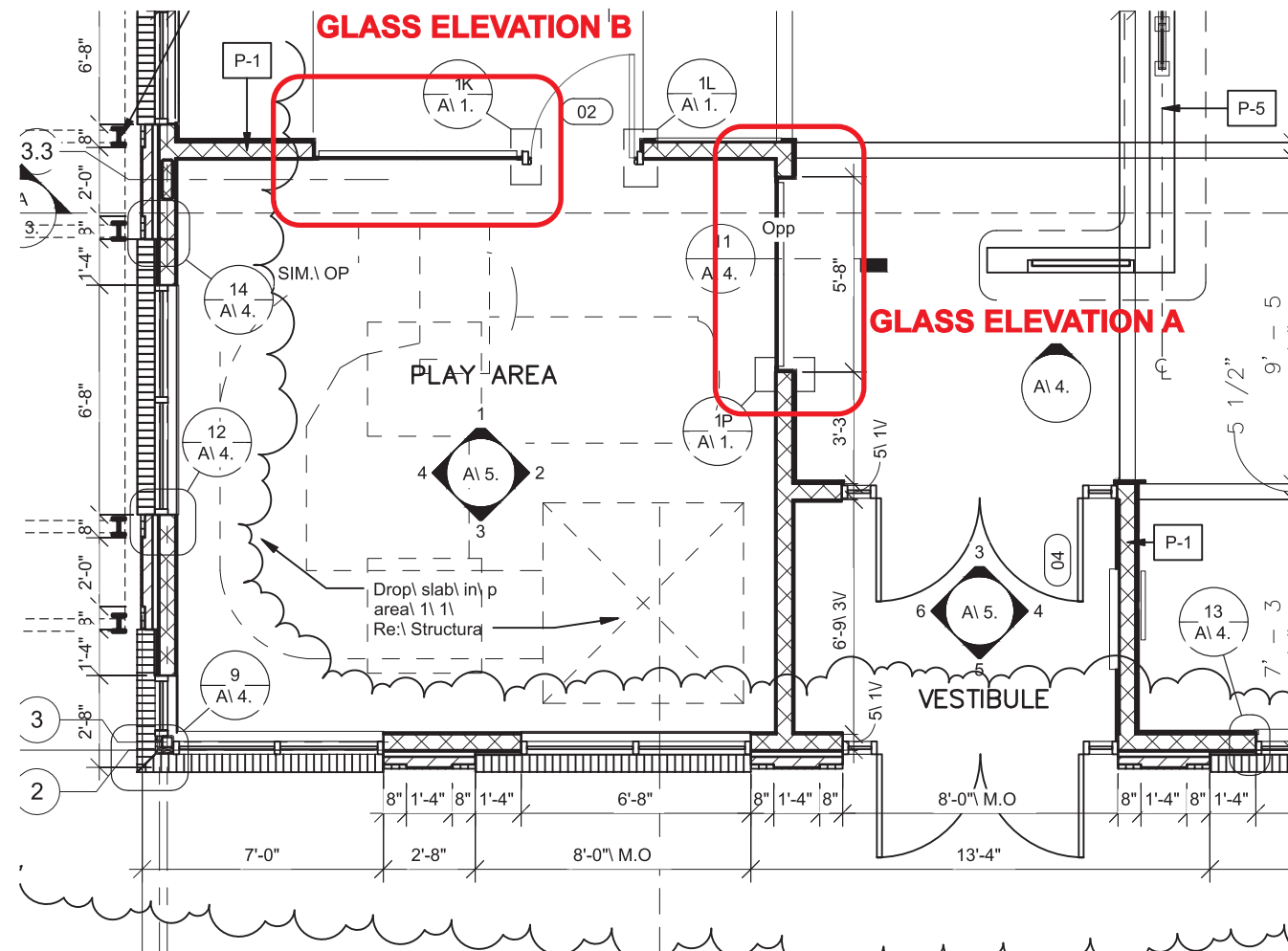

TOTAL OF 20 DOTS

TOTAL OF 20 DOTS

GLASS ELEVATION A

SCALE - 1/4" = 1'-0"

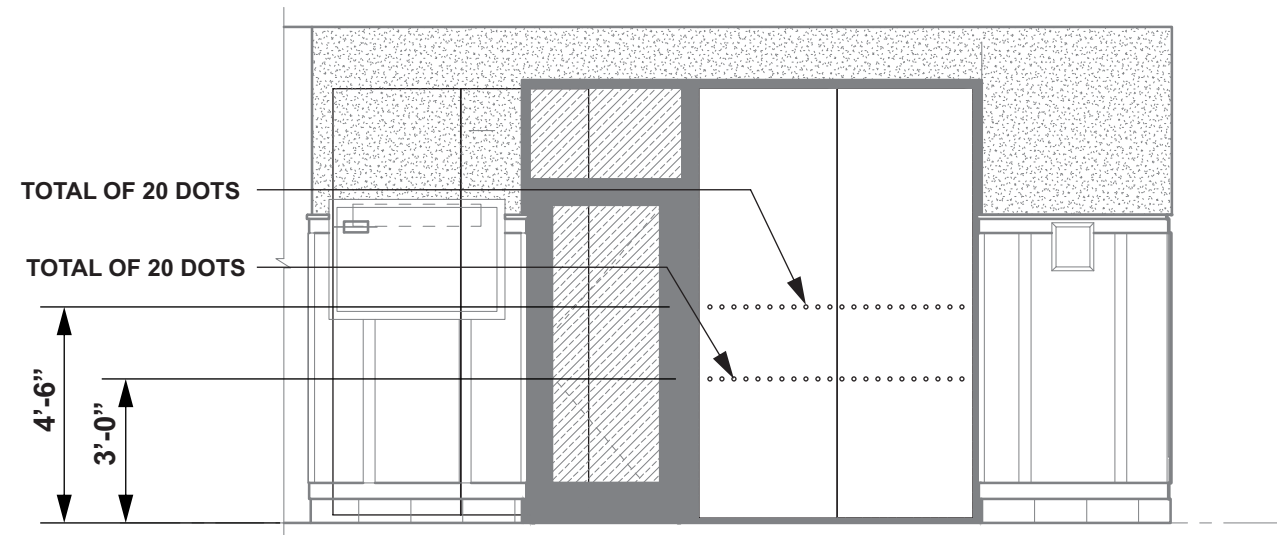

TOTAL OF 20 DOTS

TOTAL OF 20 DOTS

GLASS ELEVATION B

SCALE - 1/4" = 1'-0"



5198 North Lake Drive
Lake City, GA 30260
404-361-3800 fax 404-361-7038
website - www.claytonsigns.com

S and R

DRAWING FILE -

ALL ELECTRICAL
SIGNS ARE
120 VOLTS
UNLESS
OTHERWISE INDICATED

DRAWN BY BRANDON GUEST
ACCOUNT REP. BRANDON GUEST
DRAWING DATE 11-22-17

STORE NUMBER
534

STORE ADDRESS
Chick-Fil-A
115 Cherokee Place
Cartersville, GA 30127
Cherokee Place

THIS DRAWING IS AN ORIGINAL, UNPUBLISHED DESIGN CREATED BY CLAYTON SIGNS, INC. IT IS NOT TO BE REPRODUCED, CHANGED, OR EXHIBITED TO ANYONE OUTSIDE OF YOUR COMPANY IN WHOLE OR IN PART WITHOUT WRITTEN PERMISSION FROM THE OWNER OF CLAYTON SIGNS, INC.. ANY SUCH ACTIONS MAY BE SUBJECT TO LEGAL ACTION IN A COURT OF LAW.
© 2005 ALL RIGHTS RESERVED

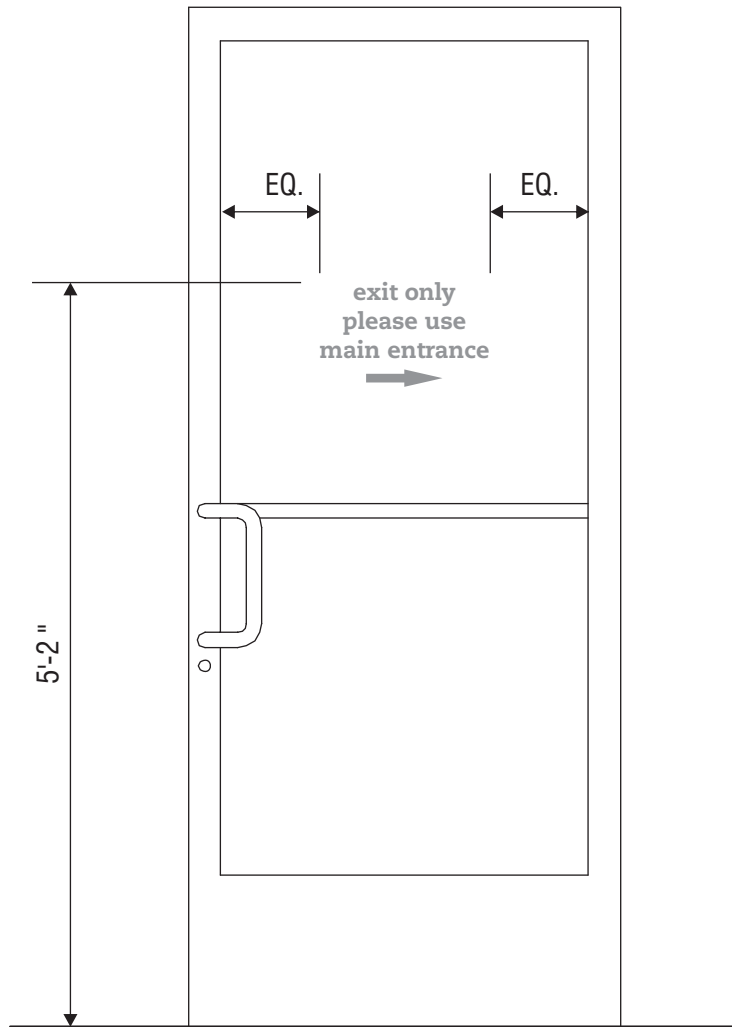

ELEVATION

SCALE - 3/4" = 1'- 0"

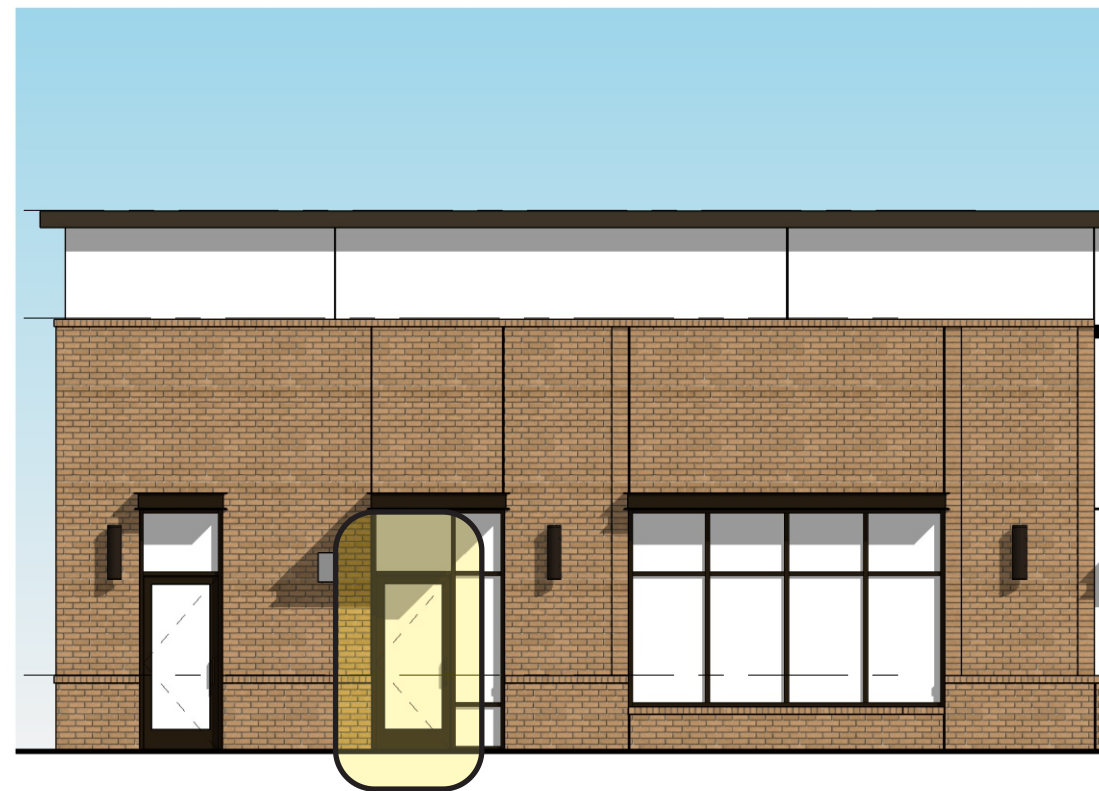
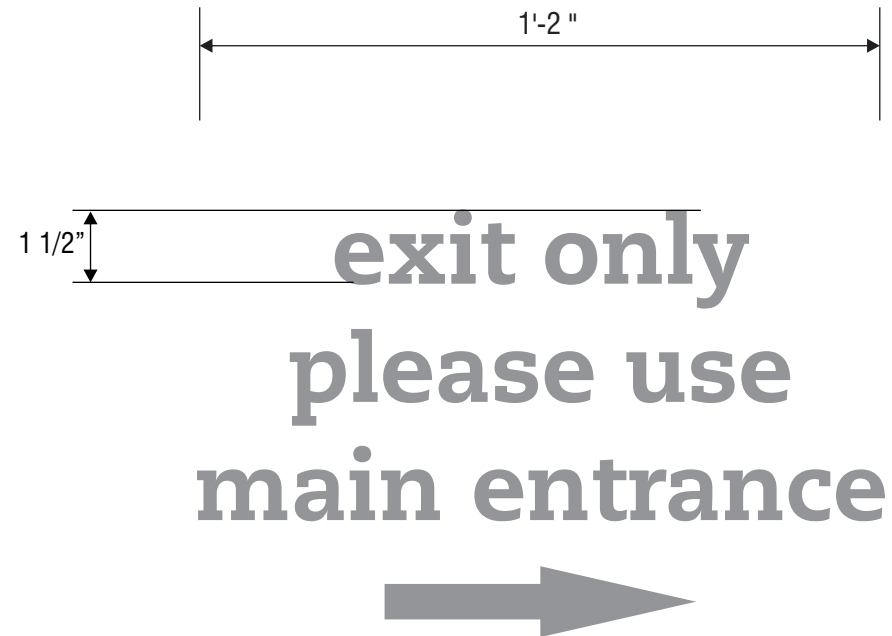

ELEVATION

SCALE - 1/8" = 1'- 0"



5198 North Lake Drive
Lake City, GA 30260
404-361-3800 fax 404-361-7038
website - www.claytonsigns.com

S and R

DRAWING FILE -

ALL ELECTRICAL
SIGNS ARE
120 VOLTS
UNLESS
OTHERWISE INDICATED

DRAWN BY BRANDON GUEST
ACCOUNT REP. BRANDON GUEST
DRAWING DATE 11-22-17

STORE NUMBER
534

STORE ADDRESS
Chick-Fil-A
115 Cherokee Place
Cartersville, GA 30127
Cherokee Place

THIS DRAWING IS AN ORIGINAL, UNPUBLISHED DESIGN CREATED BY CLAYTON SIGNS, INC. IT IS NOT TO BE REPRODUCED, CHANGED, OR EXHIBITED TO ANYONE OUTSIDE OF YOUR COMPANY IN WHOLE OR IN PART WITHOUT WRITTEN PERMISSION FROM THE OWNER OF CLAYTON SIGNS, INC.. ANY SUCH ACTIONS MAY BE SUBJECT TO LEGAL ACTION IN A COURT OF LAW.
© 2005 ALL RIGHTS RESERVED

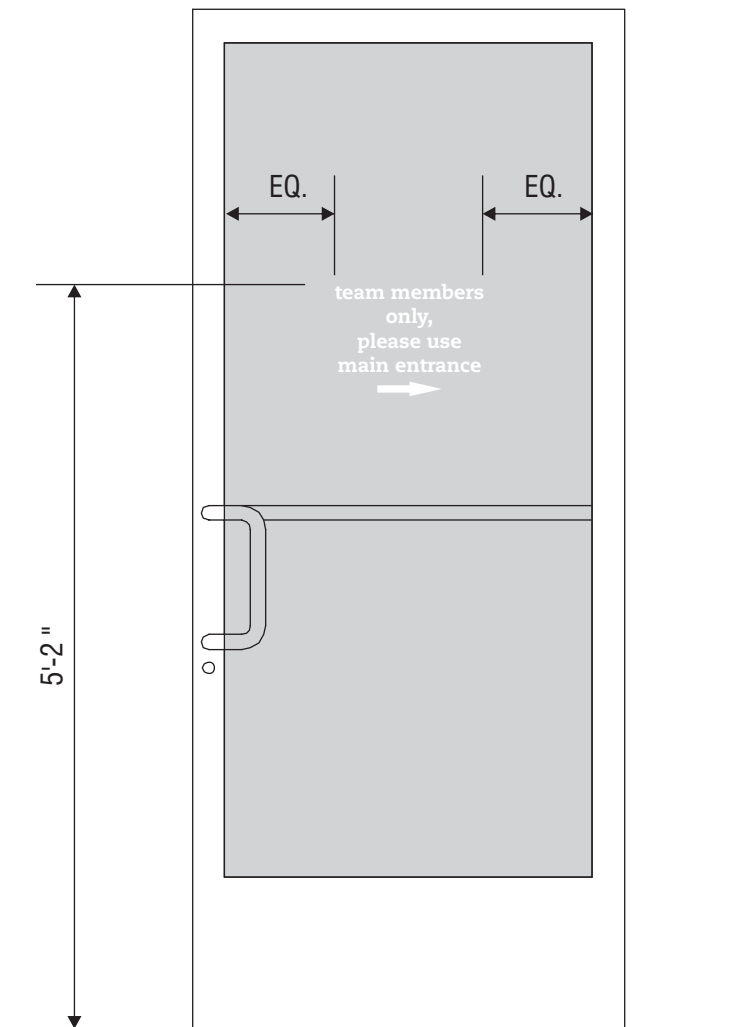

ELEVATION

SCALE - 3/4" = 1'- 0"

**FROSTED VINYL
WITH WHITE COPY**

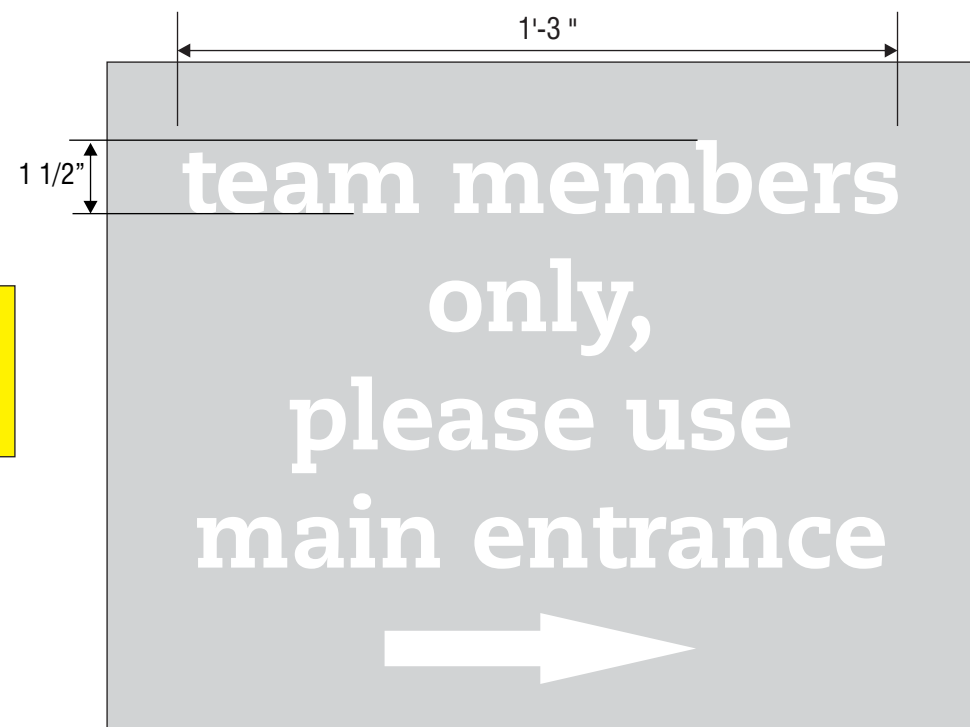

ELEVATION

SCALE - 1/8" = 1'- 0"



5198 North Lake Drive
Lake City, GA 30260
404-361-3800 fax 404-361-7038
website - www.claytonsigns.com

S and R

DRAWING FILE -

ALL ELECTRICAL
SIGNS ARE
120 VOLTS
UNLESS
OTHERWISE INDICATED

DRAWN BY BRANDON GUEST

ACCOUNT REP. BRANDON GUEST

DRAWING DATE 11-22-17

STORE NUMBER

534

STORE ADDRESS

Chick-Fil-A
115 Cherokee Place
Cartersville, GA 30127
Cherokee Place

THIS DRAWING IS AN ORIGINAL, UNPUBLISHED DESIGN CREATED BY CLAYTON SIGNS, INC. IT IS NOT TO BE REPRODUCED, CHANGED, OR EXHIBITED TO ANYONE OUTSIDE OF YOUR COMPANY IN WHOLE OR IN PART WITHOUT WRITTEN PERMISSION FROM THE OWNER OF CLAYTON SIGNS, INC.. ANY SUCH ACTIONS MAY BE SUBJECT TO LEGAL ACTION IN A COURT OF LAW.

© 2005 ALL RIGHTS RESERVED

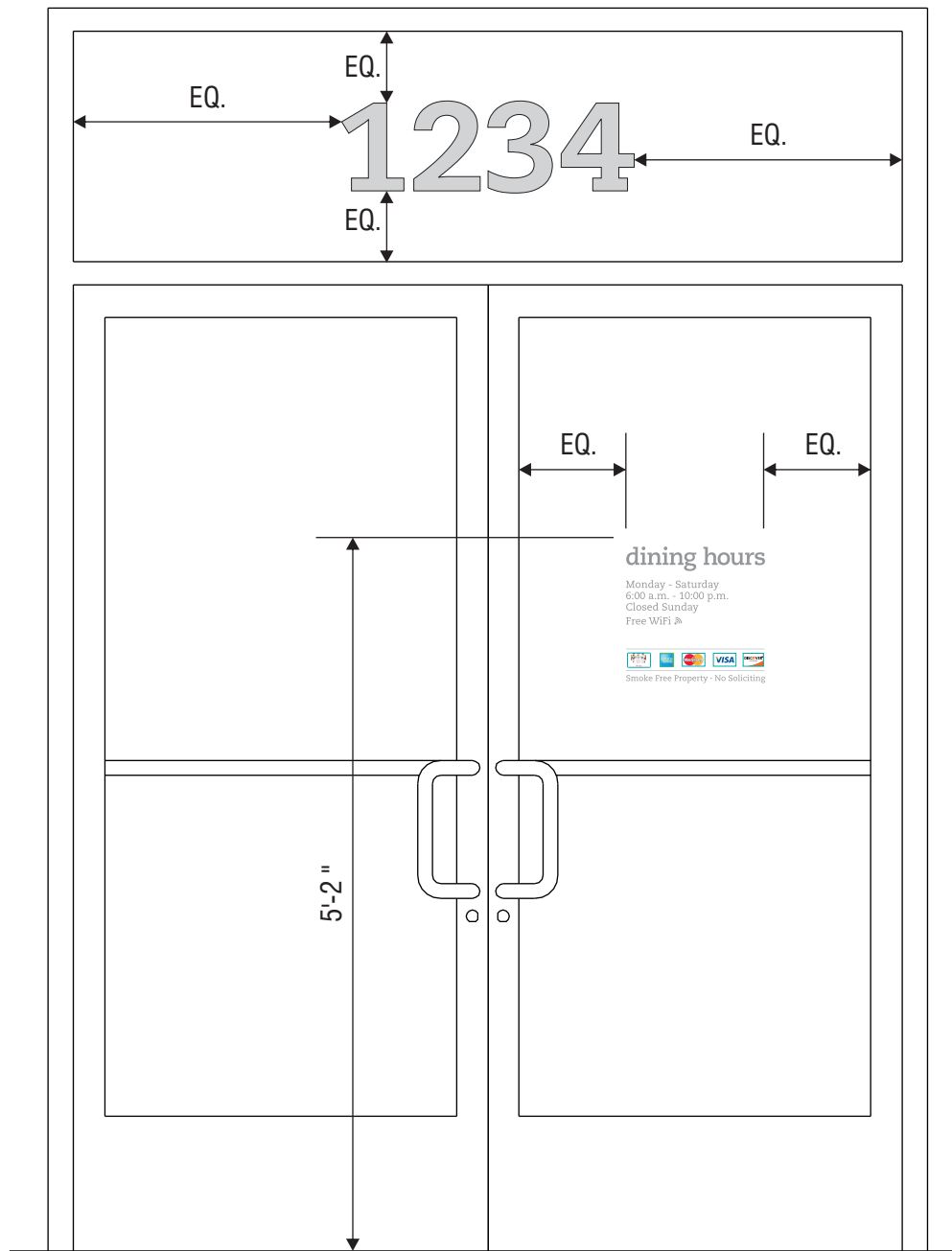

ELEVATION

SCALE - 3/4" = 1'- 0"

VERIFY ADDRESS BEFORE MAKING NUMBERS

1234

8" TALL ADDRESS NUMBERS
AVERY SC 900-810-0 LIGHT GREY VINYL FILM
APPLIED TO INTERIOR SURFACE OF GLASS
CAESCILIA COM 55 ROMAN FONT

ELEVATION

SCALE - 3" = 1'- 0"



LETTERING IS WHITE VINYL FILM
CREDIT CARD LOGOS ARE PRINTED DECALS ON CLEAR FILM
ALL GRAPHICS ARE APPLIED TO INTERIOR SURFACE OF GLASS

ELEVATION

SCALE - 3" = 1'- 0"



MAIN ENTRY ELEVATION

SCALE - 1/16" = 1'- 0"



5198 North Lake Drive
Lake City, GA 30260
404-361-3800 fax 404-361-7038
website - www.claytonsigns.com

S and R

DRAWING FILE -

ALL ELECTRICAL
SIGNS ARE
120 VOLTS
UNLESS
OTHERWISE INDICATED

DRAWN BY BRANDON GUEST
ACCOUNT REP. BRANDON GUEST
DRAWING DATE 11-22-17

STORE NUMBER
534

STORE ADDRESS
Chick-Fil-A
115 Cherokee Place
Cartersville, GA 30127
Cherokee Place

THIS DRAWING IS AN ORIGINAL, UNPUBLISHED DESIGN CREATED BY CLAYTON SIGNS, INC. IT IS NOT TO BE REPRODUCED, CHANGED, OR EXHIBITED TO ANYONE OUTSIDE OF YOUR COMPANY IN WHOLE OR IN PART WITHOUT WRITTEN PERMISSION FROM THE OWNER OF CLAYTON SIGNS, INC.. ANY SUCH ACTIONS MAY BE SUBJECT TO LEGAL ACTION IN A COURT OF LAW.
© 2005 ALL RIGHTS RESERVED