

RECORD of SURVEY BOUNDARY LINE ADJUSTMENT

for
WILLIAM STEWART NEELY, JR. and JENNY NEELY
2019-0007930

BEING A PORTION OF THE NE AND SE 1/4 SECTION 23 AND THE NE 1/4 SECTION 26
T. 7 N., R. 10 E., M. D. M.
COUNTY OF AMADOR, STATE OF CALIFORNIA



January, 2020

Scale: 1" = 400'

NOTES and LEGEND

- DENOTES 3/4" REBAR WITH PLASTIC CAP STAMPED PLS 3570 SET ON THIS SURVEY
- DENOTES FOUND FENCE ANGLE POST AS NOTED ON PLAT
- DENOTES FOUND 5/8" STEEL ROD TAGGED LS 4658 PER 56-M-65 ON THIS SURVEY
- ▲— DENOTES FOUND 3/4" IRON PIPE, NO TAG, IN RECORD LOCATION PER 56-M-65, AFFIXED TAG PLS 3570
- DENOTES A CALCULATED POINT ONLY, NOTHING FOUND OR SET
- ⊗— DENOTES FOUND 5/8" REBAR TAGGED LS 7386 PER 63-M-5
- ⊙— DENOTES FOUND 3/4" IRON PIPE TAGGED LS 3606 PER 56-M-65
- DENOTES FOUND 5/8" STEEL ROD, NO TAG, IN RECORD LOCATION PER 56-M-65, AFFIXED TAG PLS 3570
- ⊗— DENOTES FOUND FENCE ANGLE POST, NO TAG, AFFIXED TAG PLS 3570
- (1) DENOTES RECORD DATA PER 63-M-5
- (2) DENOTES RECORD DATA PER 56-M-65
- (M) DENOTES MEASURED
- SFN DENOTES SEARCHED FOUND NOTHING
- CL DENOTES CENTERLINE OR DISTANCE TO CENTERLINE
- PUE DENOTES PUBLIC UTILITY EASEMENT

BASIS OF BEARINGS IS REFERRED TO THE NORTH LINE OF "ADJUSTED PARCEL 1A" AS SHOWN ON 63-M-5, THE BEARING OF WHICH IS N 89°04'56" E.

ADJACENT OWNER TABLE		
A	SANTINELLI	2004-0002150
B	SANTINELLI	2005-0007238
C	SANTINELLI	2005-0007239
D	FANCHER	2003-0007465
E	FANCHER	2003-0007465
F	FANCHER	2003-0007465
G	FANCHER	2006-0003571
H	PINOTTI TRUST	1994-0009589
I	PINOTTI TRUST	1994-0009589
J	MOORE	435-OR-58
K	MOORE	362-OR-390

DATA TABLE		
1	S 89°30'03" W	146.12'(M)
	S 89°14'44" W	144.33'(2)
2	S 23°18'22" W	456.02'(M)
	S 24°26'53" W	456.00'(2)
3	S 89°44'38" W	127.67'(M)
	S 89°05'07" W	126.97'(2)
4	S 08°20'00" W	163.95'(M)
	S 09°44'10" W	164.98'(2)
5	S 07°15'02" W	138.56'(M)
	S 08°25'07" W	138.40'(2)

SURVEYOR'S STATEMENT

THIS MAP CORRECTLY REPRESENTS A SURVEY MADE BY ME OR UNDER MY DIRECTION IN CONFORMANCE WITH THE REQUIREMENTS OF THE PROFESSIONAL LAND SURVEYORS ACT AT THE REQUEST OF WILLIAM NEELY IN OCTOBER OF 2019.

DATE: JANUARY 22, 2020

C. L. Toma
CIRO L. TOMA P.L.S. 3570
MY LICENSE EXPIRES 6-30-2020

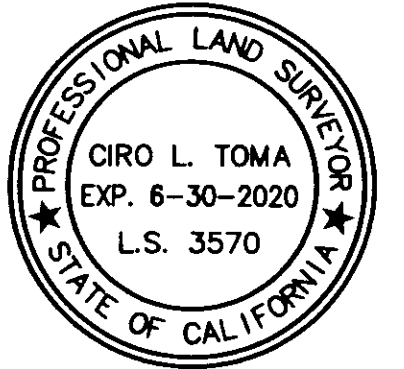

COUNTY SURVEYOR'S STATEMENT

THIS MAP HAS BEEN EXAMINED IN ACCORDANCE WITH SECTION 8766 OF THE PROFESSIONAL LAND SURVEYORS ACT THIS 23RD DAY OF JANUARY, 2020.

George E. Allen
GEORGE E. ALLEN LS 4951
INTERIM AMADOR COUNTY SURVEYOR
MY LICENSE EXPIRES 12-31-2021

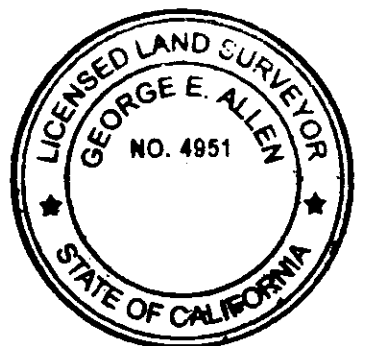

COMPLIANCE CERTIFICATE

THIS BOUNDARY LINE ADJUSTMENT IS IN COMPLIANCE WITH THE PROVISIONS OF THE SUBDIVISION MAP ACT, DIVISION 2 OF TITLE 7 OF THE GOVERNMENT CODE, AND ANY APPLICABLE ORDINANCE ENACTED PURSUANT THERETO.

THIS ADJUSTMENT MUST BE COMPLETED IN ALL ASPECTS BY THE 16th DAY OF JANUARY, 2021. THE EXCHANGE OF DEEDS OR COMPLIANCE CERTIFICATES MUST BE RECORDED BEFORE THE ABOVE DATE PER ORDINANCE No. 1445, CHAPTER 17.89 OF THE AMADOR COUNTY CODE.

DATE: 1-23-20

George E. Allen
GEORGE E. ALLEN LS 4951
INTERIM AMADOR COUNTY SURVEYOR
MY LICENSE EXPIRES 12-31-2021

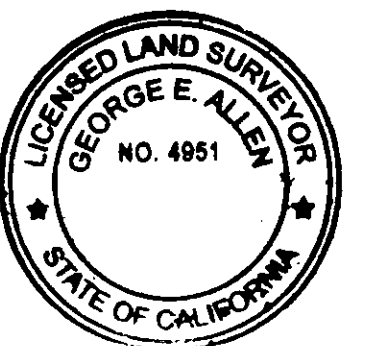

RECORDER'S STATEMENT

FILED THIS 23rd DAY OF January, 2020 AT 1:36 P.M.
IN BOOK 66 OF MAPS AND PLATS AT PAGE 26 AT THE REQUEST OF
THE AMADOR COUNTY SURVEYOR.

FEE: \$150 pdl filed

INSTRUMENT No.: 2020-0000549

Kimberly L. Grady
KIMBERLY L. GRADY
AMADOR COUNTY RECORDER

BY: *W. Gutierrez*
DEPUTY