

Bk 42 Pg 42

CORNER RECORD

Document Number CR 4686

City of OAKLAND

County of ALAMEDA, California

Brief Legal Description IRON PIN MONUMENT LOCATED WITHIN THE INTERSECTION OF 12TH STREET AND BROADWAY.

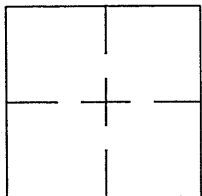

CORNER RECORD

Government Corner ☐ Control ☒
Meander ☐ Property ☐
Rancho ☐ Other ☐
Date of Survey 9/14/11

COORDINATES
(Optional)

N. _____
E. _____
Zone _____ Datum _____
Elev. _____

Corner — Left as found ☒ Found and tagged ☐ Established ☐ Reestablished ☐ Rebuilt ☐

Identification and type of corner found: Evidence used to identify or procedure used to establish or reestablish the corner:
FOUND IRON PIN MONUMENT LOCATED WITHIN THE INTERSECTION OF 12TH STREET AND BROADWAY.

AS SHOWN ON CITY OF OAKLAND MONUMENT MAP, PAGE 203.

NO CITY MONUMENT DESIGNATION NUMBER AT SUBJECT LOCATION.

THIS POINT WAS REFERENCED PRIOR TO A CONSTRUCTION PROJECT IN THE VICINITY.

A description of the physical condition of the monument as found and as set or reset: _____

FOUND AND SET POINTS AS SHOWN ON PAGE 2.

THESE TIES ARE FOR THE PURPOSE OF PERPETUATING THE FOUND MONUMENTATION.

NO CLAIM IS MADE AS TO THE RELATIONSHIP OF THE POINTS OR LINES SHOWN HEREON TO TRUE BOUNDARY LOCATIONS.

SURVEYOR'S STATEMENT

This Corner Record was prepared by me or under my direction in conformance with the Land Surveyors' Act on SEPTEMBER 21, 2011.

Signed Vincent H. Cunha L.S. Number LS 4520
VINCENT H. CUNHA



COUNTY SURVEYOR'S STATEMENT

This Corner Record was received 9-29-2011 and examined

and filed 11-21-2011

Signed Russell R. Penland, Jr. Title COUNTY SURVEYOR

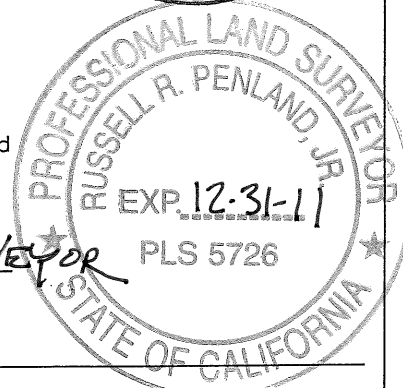

County Surveyor's Comment _____

SCALE : 1"=40'

LEGEND

- FOUND IRON PIN IN MONUMENT WELL
- ⊗ SET NAIL AND TAG LS 4520
- ✕ FOUND CUT CROSS IN CONCRETE

