

BASE CONTACT:
LAFAYE MILLER
SERVICES BUSINESS MANAGER
ARMY & AIR FORCE EXCHANGE SERVICE
EMAIL: millerla@aafes.com
OFFICE: (580) 248-7006 x221

ARCHITECT:
GARY WANG & ASSOCIATES
 1000 CORPORATE CENTER DRIVE, SUITE 550
 MONTEREY PARK, CA 91754
 ATTN: DALMAR DURAN
 EMAIL: dalmar@garywang.com
 CELL: (323) 243-3608

PROJECT CONTACT:
ATTN: KENNY TRINH
FOCUS GROUP
2388 COLBY COURT
SNELLVILLE, GA 30078
EMAIL: kenny.trinh@pandarg.com
PHONE: (404) 860-3808

MPE:
PIVOT ENGINEERING
11226 EVERGREEN LOOP
CORONA, CA 92883
ATTN: MOSTAFA ZUBAIR
EMAIL: mzubair@peccusa.com
CELL: (909) 610-5364



PANDA EXPRESS
TROOP STORE FOOD COURT
SHEPPARD AFB, TX

BID SET - 2023/11/10
(NOT FOR CONSTRUCTION)

[illegible]

PANDA RESTAURANT GROUP INC.
1683 Walnut Grove Ave.
Rosemead, California
91770
Telephone: 626.799.9898
Facsimile: 626.372.8288

All ideas, designs, arrangement and plans indicated or represented by this drawing are the property of Panda Express Inc. and were created for use on this specific project. None of these ideas, designs, arrangements or plans may be used by or disclosed to any person, firm, or corporation without the written permission of Panda Express Inc.

REVISIONS:

| | | |
|--|--|--|
| | | |
| | | |
| | | |
| | | |
| | | |
| | | |
| | | |
| | | |
| | | |
| | | |
| | | |
| | | |
| | | |
| | | |
| | | |
| | | |
| | | |
| | | |
| | | |
| | | |
| | | |

ISSUE DATE:

| | | |
|---|---------------|------------|
| 1 | 35% SUBMITTAL | 06/23/2023 |
| 2 | 95% SUBMITTAL | 10/04/2023 |
| 3 | BID SET | 11/10/2023 |
| | | |
| | | |
| | | |
| | | |
| | | |

DRAWN BY: STAFF

PANDA PROJECT #:

ARCH PROJECT #:

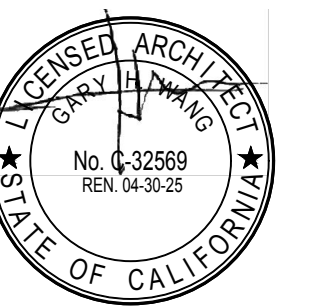

PANDA EXPRESS
BLDG 740 TROOP STORE FOOD COURT
SHEPPARD AFB, TX
76311

G-001

TITLE SHEET

| | | |
|---|--|-------|
| TEAM DIRECTORY | | 1 |
| | | G-001 |
| PROJECT DESCRIPTION: | | |
| CONVERSION OF AN EXISTING RESTAURANT SPACE TO A NEW PANDA EXPRESS RESTAURANT | | |
| SCOPE OF WORK: | | |
| NEW KITCHEN EQUIPMENT, CEILING WORK, NEW LIGHTING, NEW EXHAUST HOOD, NEW INTERIOR FINISHES, FIRE ALARM AND FIRE SPRINKLER MODIFICATION | | |
| APPLICABLE CODES: | | |
| 2018 INTERNATIONAL BUILDING CODE | | |
| 2018 INTERNATIONAL PLUMBING CODE | | |
| 2018 INTERNATIONAL ELECTRICAL CODE | | |
| NFPA 101 | | |
| NFPA 3-600-01 CHANGE TO 6 AND NFPA 96 | | |
| <ul style="list-style-type: none"> IN ACCORDANCE WITH UFC 3-600-01; 4-19.1.2 RANGE HOOD FIRE EXTINGUISHING SYSTEM MUST BE WET CHEMICAL OR WATER ASSITED WET CHEMICAL DESIGNED AND INSTALLED IN ACCORDANCE WITH NFPA 96 | | |
| NUMBER OF STORIES: | 1-STORY BUILDING | |
| FIRE SPRINKLER: | SPRINKLERED | |
| PROJECT OCCUPANCY: | A-2 (RESTAURANT) | |
| LEASE AREA: | 715 SF | |
| OCCUPANT LOAD CALCULATION: | | |
| KITCHEN/ SERVICE: | 690 SF/ 200 SF = 4 OCCUPANTS | |
| WALK-IN BOX: | 60 SF/ 0 SF = 0 OCCUPANT | |
| TOTAL: | 4 OCCUPANTS | |
| NUMBER OF EMPLOYEES: | 4 EMPLOYEES PER SHIFT/ 2-SHIFTS PER DAY | |
| PROJECT SUMMARY/ CODE ANALYSIS | | 2 |
| | | G-001 |
| <ol style="list-style-type: none"> IT SHALL BE THE RESPONSIBILITY OF THE GENERAL CONTRACTOR TO FULLY EXAMINE THE SITE CONDITION, AND AVAILABLE UTILITIES AND TO NOTIFY THE OWNER'S REPRESENTATIVE, IN WRITING OF ANY AND ALL DISCREPANCIES BETWEEN THE SAID EXISTING CONDITIONS AND THESE DRAWINGS. NO CLAIMS FOR ADDITIONAL COMPENSATION SHALL BE MADE OR SHALL BE VALID UNLESS WRITTEN NOTIFICATION IS RECEIVED BY THE OWNER'S REPRESENTATIVE AND THE ADDITIONAL COMPENSATION IS APPROVED IN ADVANCE OF PROCEEDING WITH THE WORK. IN ADDITION TO THE GENERAL NOTES LISTED HEREIN, A.I.A. DOCUMENT A201 GENERAL CONDITIONS OF THE CONTRACT FOR CONSTRUCTION SHALL APPLY. ALL WORK SHALL BE PERFORMED AS TO COMPLY WITH ALL GOVERNING STATUTES, ORDINANCES, REGULATIONS, CODES AND INSURANCE RATING BOARDS. NO WORK SHALL COMMENCE UNTIL ALL GOVERNMENTAL AND JURISDICTIONAL PERMITS AND APPROVALS ARE OBTAINED. ALL WORK SHALL BE PERFORMED IN A FIRST CLASS MANNER AND SHALL BE IN GOOD AND USABLE CONDITION AT THE DATE OF COMPLETION THEREOF. UNDER NO CIRCUMSTANCES SHALL THE CONTRACTOR INSTALL OR PERMIT TO BE INSTALLED, ANY MATERIALS CONTAINING ASBESTOS. THE TERM "OWNER" OR "TENANT" SHALL REFER TO PANDA EXPRESS LICENSEE AND ITS AGENTS OR REPRESENTATIVES. THE TERM "GENERAL CONTRACTOR" AND "G.C." SHALL REFER TO THE PERSON AND / OR PERSONS WHO HAVE CONTRACTED OR SUBCONTRACTED FOR THE WORK. THE ABBREVIATION OF "N.I.C." INDICATES WORK AND OR MATERIAL THAT IS NOT IN THE CONTRACT OF THE GENERAL CONTRACTOR, HOWEVER THIS DOES NOT RELIEVE THE G.C. OF THE RESPONSIBILITY OF COORDINATION. THE LOCATIONS OF EXISTING UTILITIES ARE SHOWN IN AN APPROXIMATE WAY ONLY AND HAVE NOT BEEN INDIVIDUALLY VERIFIED BY THE OWNER OR HIS REPRESENTATIVE. THE CONTRACTOR SHALL DETERMINE THE EXACT LOCATION OF ALL EXISTING UTILITIES BEFORE COMMENCING WORK, AND AGREES TO BE FULLY RESPONSIBLE FOR ANY AND ALL DAMAGES WHICH MIGHT OCCUR BY THE CONTRACTOR'S FAILURE TO EXACTLY LOCATE AND PRESERVE ANY AND ALL UTILITIES. ALL MECHANICAL, PLUMBING AND ELECTRICAL FLOOR PLAN LAYOUTS ARE SHOWN SCHEMATIC IN NATURE. IT IS THE G.C.'s RESPONSIBILITY TO DETERMINE ACTUAL LOCATIONS TO ACCOMMODATE THE EXISTING CONDITIONS. WHEN BIDDING THE PROJECT, IT IS HIGHLY RECOMMENDED THAT THE G.C. AND ALL ITS SUB-CONTRACTORS VISIT THE PROJECT SITE TO FAMILIARIZE THEMSELVES WITH THE PROJECT. IT IS ASSUMED THAT THE G.C. AND ALL ITS SUB-CONTRACTORS HAVE CONSIDERED ALL EXISTING CONDITIONS ON THEIR COSTS WHEN BIDS ARE SUBMITTED. | | |
| GENERAL NOTES | | 3 |
| | | G-001 |



| | |
|----------------------|-------|
| CONCEPTUAL RENDERING | 4 |
| | G-001 |

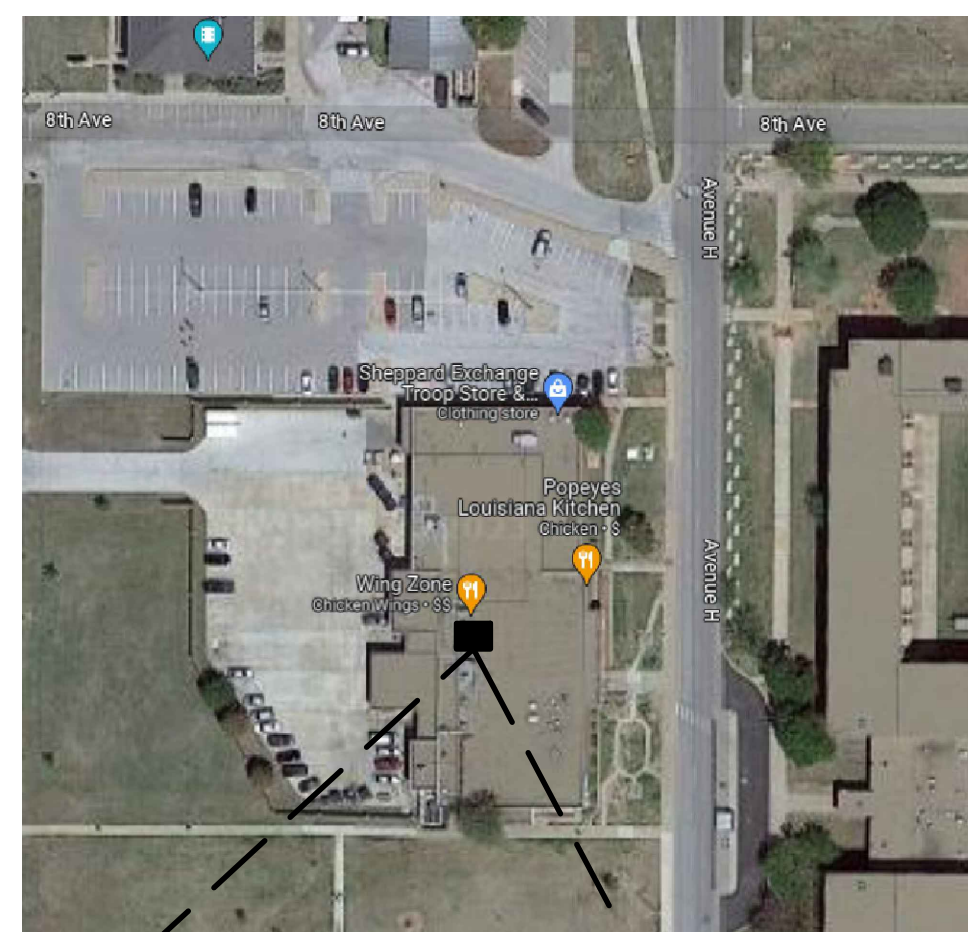
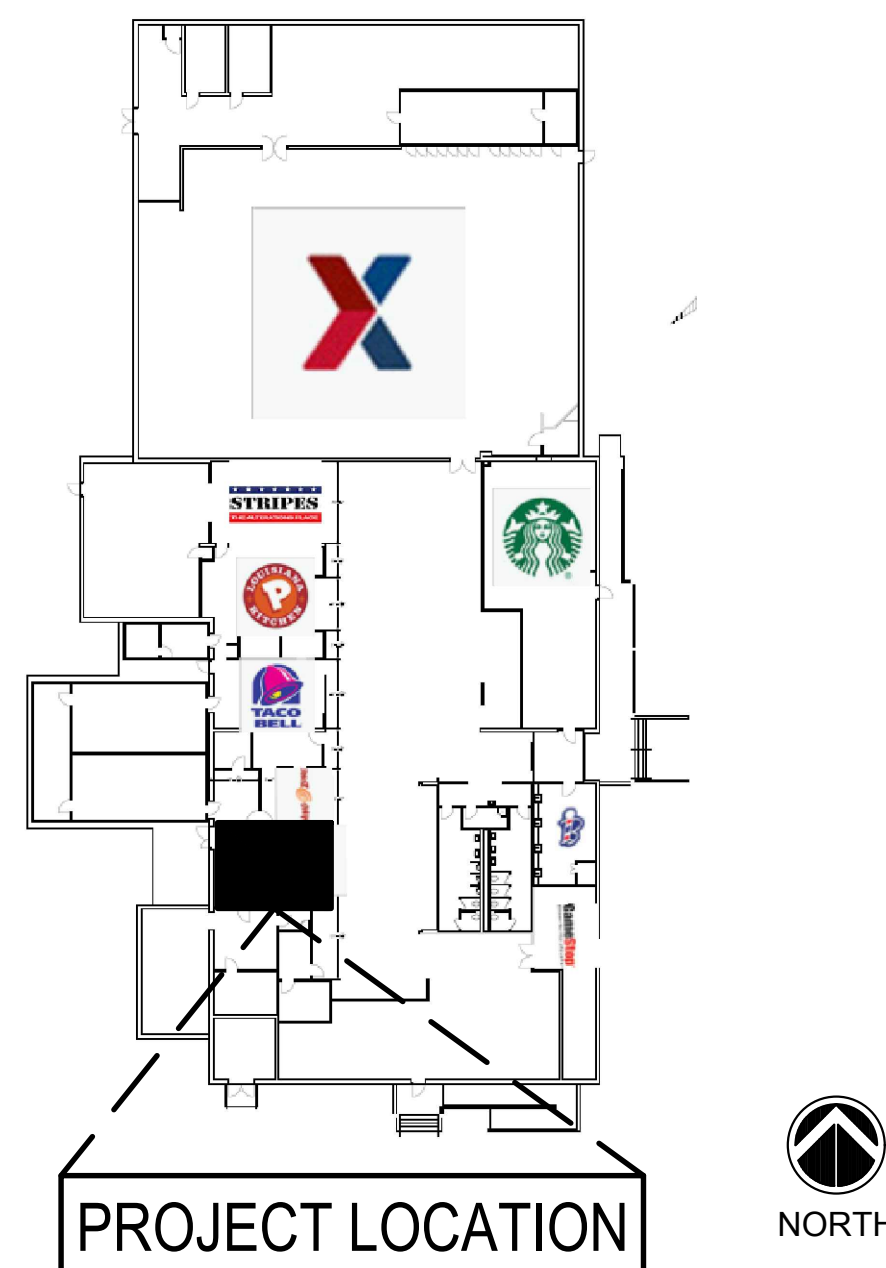

PROJECT LOCATION

GENERAL CONDITIONS FOR THE CONTRACT FOR CONSTRUCTION

ARTICLE 1 - GENERAL PROVISIONS

1. THE STANDARD FORM OF GENERAL CONDITIONS, CURRENT EDITION OF THE AMERICAN INSTITUTE OF ARCHITECTS, DOCUMENT NO. A-201, ARE HEREBY MADE A PART OF THESE SPECIFICATIONS AND SHALL APPLY THE SAME AS IF REPEATED HERE IN FULL. COPIES OF SAME SHALL BE ON FILE AT THE OFFICE OF THE ARCHITECT.

2. ALL INTERESTED PARTIES SHALL BE GOVERNED BY THOSE GENERAL CONDITIONS IN ALL MATTERS PERTAINING TO THIS PROJECT, DURING THE PERIOD OF CONSTRUCTION, AND PARTICIPATION IN THE PROJECT WILL BE CONSIDERED PRESUMPTIVE EVIDENCE OF THE PARTICIPANT'S FULL UNDERSTANDING OF, AND AGREEMENT WITH, THE CONDITIONS OF THE REFERENCED GENERAL CONDITIONS.

3. THE GENERAL CONDITIONS, SPECIAL PROVISIONS, GENERAL REQUIREMENTS, AND TECHNICAL SPECIFICATIONS, ALONG WITH THE OTHER CONDITIONS WHICH FOLLOW, AND AS PROVIDED, AS WELL AS ALL APPLICABLE PROVISIONS OF THE SPECIFICATIONS, FORM A PART OF THE CONTRACT AND SHALL GOVERN EACH CONTRACTOR ENGAGED IN WORK ON THE PROJECT WHETHER THE WORK BE LET UNDER SEPARATE CONTRACTS OR UNDER A SINGLE CONTRACT.

4. BASIC DEFINITIONS: THE CONTRACT DOCUMENTS CONSIST OF THE AGREEMENT BETWEEN OWNER AND CONTRACTOR, CONDITIONS OF THE CONTRACT AND ALL DOCUMENTS LISTED BELOW.

THE CONTRACT DOCUMENTS SHALL INCLUDE: DRAWINGS AS LISTED IN THE INDEX OF THIS SET, SPECIFICATION DIVISION 1-16 INCLUSIVE, ALL MODIFICATIONS ISSUED AFTER EXECUTION OF THE CONTRACT, EQUIPMENT INSTALLATION HAND BOOK.

5. PHRASES USED IN THE SPECIFICATIONS ARE DEFINED AS FOLLOWS: "AS SHOWN" - AS SHOWN ON THE ACCOMPANYING DRAWINGS.

"PROVIDE" - PROVIDE AND INSTALL COMPLETE, WITH ALL NECESSARY ACCESSORIES AND INCIDENTAL MATERIALS AND SUPPLIES.

"PROVIDED BY OWNER" - MATERIALS OR GOODS WILL BE DELIVERED F.O.B. JOBSITE BY THE OWNER AT NO EXPENSE TO THE GENERAL CONTRACTOR. UNLOADING, STORAGE, INSTALLATION, AND/OR ASSEMBLY OF ITEMS PROVIDED BY OWNER SHALL BE BY GENERAL CONTRACTOR UNLESS OTHERWISE NOTED.

"INSTALL" - INSTALL ITEMS, COMPLETE, PROVIDING ALL INCIDENTAL AND NECESSARY SUPPLIES AND MATERIALS.

"GENERAL CONTRACTOR" - THE GENERAL CONTRACTOR OR ANY OR ALL OF HIS VARIOUS SUBCONTRACTORS.

"OWNER" - ALL GENERAL CONDITIONS REFERENCES TO "OWNER" SHALL REFER TO PANDA EXPRESS, INC.

"CONTRACTOR" AND "GENERAL CONTRACTOR" AS STATED IN THESE DOCUMENTS REFER TO THE SAME ENTITY.

ARTICLE 2 - INSURANCE

THE GENERAL CONTRACTOR AND ALL SUBCONTRACTORS ARE REQUIRED TO OBTAIN THE FOLLOWING INSURANCES, AND AT THEIR REQUEST FURNISH EVIDENCE TO PANDA EXPRESS. ALL INSURANCE SHALL NAME PANDA RESTAURANT GROUP, INC., AND THE ARCHITECTS, AS ADDITIONAL, INSURED PARTIES.

WORKMAN'S COMPENSATION INSURANCE IN ACCORDANCE WITH THE LAWS OF THE STATE IN WHICH THE PROPERTY IS LOCATED AND PANDA EXPRESS REQUIREMENTS. PANDA EXPRESS SHALL KEEP A COPY IN FILE ALL TIME.

COMPREHENSIVE GENERAL LIABILITY INSURANCE INCLUDING CONTRACTUAL LIABILITY WITH LIMITS SET FORTH BY THE PANDA EXPRESS.

AUTOMOBILE LIABILITY INSURANCE INCLUDING CONTRACTUAL LIABILITY AS SET FORTH BY THE PANDA EXPRESS.

BUILDER'S RISK INSURANCE IN THE AMOUNT OF THE ESTIMATED COST OF THE PROJECT.

THE CONTRACTOR AGREES TO INDEMNIFY AND SAVE HARMLESS PANDA EXPRESS, ITS AGENTS, SERVANTS, AND EMPLOYEES, AND THE OWNER'S ARCHITECT AND ENGINEER FROM AND AGAINST ANY AND ALL LIABILITY OR DAMAGE TO PROPERTY OCCASIONED BY ANY ACT OR OMISSION OF THE CONTRACTOR, HIS SUBCONTRACTORS, SERVANTS, OR EMPLOYEES, INCLUDING ANY AND ALL EXPENSE, LEGAL, OR OTHERWISE, WHICH MAY BE INCURRED BY PANDA EXPRESS, ITS AGENTS SERVANTS, OR EMPLOYEES IN THE DEFENSE OF ANY CLAIM, SETTLEMENT OR SUIT.

ARTICLE 3 EXTRA WORK

1. ANY AND ALL WORK WHICH IS PERFORMED BY THE CONTRACTOR, OR BY ANY SUBCONTRACTOR, WITHOUT HAVING SPECIFIC APPROVAL FROM PANDA EXPRESS IN WRITING, SHALL BE PERFORMED BY SAID CONTRACTOR AT HIS OWN RISK WITHOUT ANY OBLIGATION OR RESPONSIBILITY OF PANDA EXPRESS OR THE ARCHITECT. ALL WORK WHICH IS ABOVE AND BEYOND THE SCOPE OF THE DRAWINGS AND SPECIFICATIONS, OR ANY PART OF THE CONSTRUCTION DOCUMENTS, MUST BE SPECIFICALLY AUTHORIZED BY PANDA EXPRESS IN WRITING. ALL REQUESTS FOR ADDITIONAL PAYMENTS MUST BE APPROVED BY THE OWNER PRIOR TO THE START OF THAT WORK.

2. THE FOLLOWING GENERAL REQUIREMENTS SUPPLEMENT AND/OR SUPERSEDE THE FOREGOING GENERAL AND SUPPLEMENTARY CONDITIONS FOR CONTRACT WORK AND ARE HEREBY CONSIDERED A PART OF THE CONTRACT DOCUMENTS.

DIVISION 1 GENERAL REQUIREMENTS

1. SCOPE

SCOPE ALL OF THE WORK UNDER EACH HEADING OF THESE SPECIFICATIONS SHALL BE GOVERNED BY THE GENERAL CONDITIONS, SPECIAL PROVISIONS, THE DRAWINGS AND THE SPECIFICATIONS, AS WELL AS THE FOLLOWING GENERAL REQUIREMENTS

THE WORK UNDER EACH HEADING OF THESE SPECIFICATIONS SHALL INCLUDE ALL LABOR, MATERIAL, EQUIPMENT AND SERVICES NECESSARY FOR AND SAID HEADING AS INDICATED ON THE DRAWINGS, SET FORTH IN THE SPECIFICATIONS, OR OTHERWISE REQUIRED.

WORK DONE HEREUNDER INCLUDES FURNISHING ALL LABOR, MATERIAL SERVICES, AND EQUIPMENT NECESSARY AND INCIDENTAL TO PERFORM ALL WORK THROUGH THE PROPER COMPLETION OF ALL WORK AS MAY BE FURTHER SPECIFIED AND/OR SHOWN ON THE PLANS, OR OTHERWISE REQUIRED.

2. CONFLICTS BETWEEN DOCUMENTS

IN CASE OF CONFLICT BETWEEN DRAWINGS AND SPECIFICATIONS THE CONTRACTOR WILL BE DEEMED TO HAVE ESTIMATED ON, AND AGREED TO PROVIDE, THE GREATEST QUANTITY AND BETTER QUALITY OF MATERIALS AND WORK.

INCLUDE GENERAL CONSTRUCTION, ELECTRICAL, PLUMBING, HVAC, AND INSTALLATION OF ALL SUCH WORK EXCEPT AS HEREINAFTER MAY BE REQUIRED.

3. ITEMS FURNISHED BY PANDA AND INSTALLED BY GENERAL CONTRACTOR

IT SHALL BE THE CONTRACTOR'S SOLE RESPONSIBILITY TO RECEIVE, CHECK AND CONFIRM THE ARRIVAL IN GOOD ORDER, OF ALL ITEMS CALLED FOR TO BE FURNISHED BY PANDA EXPRESS AND INSTALLED BY THE CONTRACTOR.

THE CONTRACTOR SHALL NOTIFY PANDA EXPRESS (IN WRITING) OF ANY SUCH ITEMS MISSING OR DAMAGED WITHIN 3 DAYS OF RECEIVING DATE. FAILURE TO SO NOTIFY PANDA EXPRESS WILL BE CONSIDERED PROOF PRESUMPTIVE THAT ALL SAID ITEMS HAVE ARRIVED UNDAMAGED, AND IN THE PROPER QUANTITIES, AND IT SHALL THEN BE THE CONTRACTOR'S RESPONSIBILITY (AT HIS OWN COST) TO PROMPTLY REORDER, REPLACE AND/OR REPAIR ANY SUCH ITEMS NEEDED FOR THE PROPER COMPLETION OF THIS PROJECT, ON THE AGREED TO DATE OF COMPLETION.

4. MEASUREMENTS

THE CONTRACTOR SHALL BE RESPONSIBLE FOR AN ACCURATE TAKING OF JOB SITE MEASUREMENTS, VERIFYING SAME, AND PROMPTLY FURNISHING EXACT JOB SITE MEASUREMENTS TO ALL PARTIES REQUIRING SAME. CONTRACTOR MUST NOTIFY PANDA EXPRESS AND THE ARCHITECT OF ANY DISCREPANCIES IMMEDIATELY. THE CONTRACTOR SHALL CHECK SALES CASEWORK SHOP DRAWINGS AS TO CORRECT ANGLES AND FIT TO THE EXISTING SPACE AS SHOWN. THE CONTRACTOR SHALL PERMANENTLY LAYOUT THE CASEWORK ON THE FLOOR PRIOR TO THE CONSTRUCTION OF WALL, CEILING, LIGHT FIXTURES, ETC.

WRITTEN DIMENSIONS SHALL TAKE PRECEDENCE OVER SCALED DIMENSIONS. LARGER SCALE DRAWINGS SHALL TAKE PRECEDENCE OVER SMALLER SCALE DRAWINGS.

5. SUBSTITUTIONS

BIDDERS MAY OFFER SUBSTITUTIONS FOR ANY ITEM SPECIFICATION BY SUBMITTING IN WRITING AS OUTLINED IN SPACE PROVIDED ON PROPOSAL FORM.

IT SHALL BE UNDERSTOOD BY ALL HEREIN CONCERNED THAT ANY PROPOSAL SUBSTITUTION SHALL HAVE THE WRITTEN APPROVAL OF ARCHITECT AND/OR OWNER'S REPRESENTATIVE, BEFORE BEING USED BY CONTRACTOR, OTHERWISE IT WILL BE ASSUMED THAT THE CONTRACTOR'S TOTAL BID IS BASED UPON THE MATERIAL OR ITEM OF EQUIPMENT SPECIFIED.

6. EXAMINATION OF SITE AND BUILDING

BEFORE SUBMITTING A PROPOSAL, EACH BIDDER SHALL EXAMINE ALL DOCUMENTS, VISIT THE SITE, VERIFYING ANY SPECIAL CHARGES OR REQUIREMENTS, COMPARING EACH TO THE OTHER AND INFORMING THEMSELVES OF ALL CONDITIONS UNDER WHICH WORK IS TO BE PERFORMED. INCLUDE ALL RELEVANT MATTERS WHICH MAY AFFECT THE WORK OR THE BIDDING. EACH BIDDER SHALL BASE HIS PROPOSAL ON MATERIAL, METHODS AND/OR EQUIPMENT COMPLYING WITH THE SPECIFICATIONS AND DRAWINGS.

THE WORDS "THE CONTRACTOR SHALL" ARE INTENTIONALLY OMITTED FROM THE SPECIFICATIONS. WHERE DIRECTIONS OR INSTRUCTIONS ARE STATED, WITHOUT SPECIFIC REFERENCE AS TO WHO IS RESPONSIBLE, THE INFERENCE IS INTENDED TO BE THE CONTRACTOR FOR THE WORK IN THE SPECIFICATION SECTION IN WHICH THE DIRECTIONS OR INSTRUCTIONS ARE INTENDED.

7. CODES AND STANDARDS

ALL WORK, MATERIALS AND INSTALLATION SHALL BE IN STRICT ACCORDANCE WITH ALL ORDINANCES, STATE AND LOCAL BUILDING CODES, LATEST EDITION, OF THE AUTHORITIES HAVING JURISDICTION.

DESIGN LOADS: LOADS AND CODE RESTRICTIONS FOR ALL DESIGN CONSIDERATIONS SHALL CONFORM TO THE LOCAL AND STATE CODES, AND ALL GOVERNING CODES.

8. PERMITS

THE CONTRACTOR SHALL BE RESPONSIBLE FOR THE PROPER APPLICATION FOR AND SECURING OF ALL NECESSARY TRADE PERMITS, AS WELL AS THE OBSERVANCE OF ALL APPLICABLE CITY, COUNTY, STATE AND FEDERAL LAWS, REGULATIONS OR ORDINANCES AND SHALL INCLUDE IN THEIR PROPOSAL COST OF SAME.

9. INSTALLATION OF MATERIALS AND EQUIPMENT

ATTENTION IS HEREBY DIRECTED TO THE FOLLOWING REQUIREMENT FOR EACH PRIME AND SUBCONTRACTOR, THAT THE APPLICATION OF A MATERIAL AND/OR EQUIPMENT ITEM TO UNSATISFACTORY WORK INSTALLED BY OTHERS, CONSTITUTES ACCEPTANCE OF THAT WORK AND ASSUMPTION OF FULL RESPONSIBILITY FOR PRIOR TO STARTING THE SPECIFIC APPLICATION, NOTIFY IN WRITING THE ARCHITECT AND/OR OWNER'S REPRESENTATIVE OF ANY DEFECT OR DEFICIENCY WHICH WOULD IMPAIR COMPLETE AND SATISFACTORY APPLICATIONS OR INSTALLATION OF HIS WORK OR GUARANTEE.

MANUFACTURER'S INSTRUCTIONS: WHERE INSTALLATIONS INCLUDE MANUFACTURED PRODUCTS, COMPLY WITH MANUFACTURER'S APPLICABLE INSTRUCTIONS AND RECOMMENDATIONS FOR INSTALLATION, TO THE EXTENT THESE ARE MORE EXPLICIT OR MORE STRINGENT THAN REQUIREMENTS INDICATED IN THE CONTRACT DOCUMENTS.

PROVIDE ATTACHMENT AND CONNECTION DEVICES AND METHODS FOR SECURING WORK PROPERLY AS IT IS INSTALLED, TRUE TO LINE AND LEVEL, AND WITHIN RECOGNIZED INDUSTRY TOLERANCES IF NOT OTHERWISE INDICATED. ALLOW FOR EXPANSIONS AND BUILDING MOVEMENTS.

VISUAL EFFECT: PROVIDE UNIFORM JOINT WIDTHS IN EXPOSED WORK, ORGANIZED FOR BEST POSSIBLE VISUAL EFFECT. REFER QUESTIONABLE VISUAL-EFFECT CHOICES TO ARCHITECT/OWNER'S REPRESENTATIVE FOR FINAL DECISION. RECHECK MEASUREMENTS AND DIMENSIONS OF THE WORK, AS AN INTEGRAL STEP OF STARTING EACH INSTALLATION.

MOUNTING HEIGHTS: WHERE MOUNTING HEIGHTS ARE NOT INDICATED, MOUNT INDIVIDUAL UNITS OF WORK AT INDUSTRY-RECOGNIZED STANDARD MOUNTING HEIGHTS FOR APPLICATIONS INDICATED. REFER QUESTIONABLE MOUNTING HEIGHT CHOICES TO ARCHITECT/OWNER'S REPRESENTATIVE FOR FINAL DECISION, CONFORM WITH APPLICABLE ACCESSIBILITY CODES WHERE REQUIRED.

10. PROTECTION AND CLEAN-UP

THE CONTRACTOR SHALL BE RESPONSIBLE FOR THE PROPER PROTECTION OF ADJACENT ITEMS AND SURFACES FROM DAMAGE RESULTING FROM THE FURNISHING OR INSTALLATION OF HIS WORK AND SHALL PROMPTLY REPLACE, AT HIS OWN COST, SUCH DAMAGED WORK. HE SHALL ALSO BE RESPONSIBLE FOR THE PROPER PROTECTION OF HIS AND OTHERS' WORK FROM DAMAGE BY ANY INCLUDING FREEZING OR OVERHEATING; USE PLASTIC COVERING OVER FURNITURE, DISPLAY CASES, EQUIPMENT, AND FINISHES. THE CONTRACTOR SHALL REMOVE ALL DEBRIS FROM THE PREMISES ON A DAILY BASIS; ALL DUST AND CONSTRUCTION DEBRIS ARE TO BE REMOVED, ANY BROKEN, DAMAGED, MARRED, UNCLEAN, OR OTHERWISE IMPERFECT WORK SHALL BE CORRECTED BY THE CONTRACTOR BEFORE HIS WORK SHALL BE CONSIDERED COMPLETE. USE DUST BARRIERS.

UPON COMPLETION OF THE WORK CONTRACTOR SHALL CLEAN INTERIOR AND EXTERIOR OF ALL GLASS AND GLAZING, FLOORS, WALLS AND CEILING SURFACES, ELECTRICAL FIXTURES, MECHANICAL EQUIPMENT, ETC.; IT IS NECESSARY TO REMOVE ALL DIRT, STAINS, AND MARKS. THE SIGNS, GLASS AND WOOD SHALL BE CLEANED AND POLISHED. THE STORE SHALL BE MADE CLEAN AND FIT FOR IMMEDIATE OCCUPANCY BY AN INDEPENDENT CLEANING AGENT, WITH THE APPROVAL OF PANDA EXPRESS, AT THE CONTRACTOR'S EXPENSE.

GENERAL CONTRACTOR SHALL SUPERVISE AND SCHEDULE PROPER INSTALLATION OF ALL PARTS OF WORK PERTAINING TO A FINISHED PRODUCT BY HIM OR BY THE OWNER.

GENERAL CONTRACTOR SHALL SUPERVISE AND SCHEDULE PROPER INSTALLATION OF ALL PARTS OF WORK PERTAINING TO A FINISHED PRODUCT BY CONTRACTOR, SUBCONTRACTORS OR PANDA EXPRESS.

11. GUARANTEE WARRANTY

THE CONTRACTOR SHALL GUARANTEE THE WORK TO BE FREE FROM DEFECTS OF MATERIALS OR WORKMANSHIP, INCLUDING DISCOLORATION, RATTLING AND LEAKING, FOR A PERIOD OF ONE YEAR FROM THE DATE OF FINAL PAYMENT. APPLICATION BY THE CONTRACTOR FOR FINAL PAYMENT SHALL BE CONSIDERED AS PRESUMPTIVE EVIDENCE OF HIS FULL UNDERSTANDING OF AND AGREEMENT WITH CONDITIONS OF THE GUARANTEE PROVISION, AND HE SHALL REMOVE AND REPLACE WITH NEW, AT HIS OWN EXPENSE, ALL SUCH WORK OR MATERIALS FOUND BY PANDA EXPRESS' REPRESENTATIVE TO BE DEFECTIVE WITHIN THE GUARANTEE PERIOD.

12. SUBCONTRACTORS

THE CONTRACTOR AGREES THAT HE IS FULLY RESPONSIBLE TO THE OWNER FOR THE ACTS AND OMISSIONS OF HIS SUBCONTRACTORS AND OF PERSONS DIRECTLY EMPLOYED BY HIM. NOTHING CONTAINED IN THE CONTRACT DOCUMENTS SHALL CREATE ANY CONTRACTUAL RELATION BETWEEN ANY SUBCONTRACTOR AND PANDA EXPRESS. THE CONTRACTOR SHALL COOPERATE WITH PANDA AND OTHER CONTRACTORS PERFORMING WORK UNDER SEPARATE CONTRACTS TO ENSURE PROJECT PROGRESS ACCORDING TO SCHEDULE. THE CONTRACTOR SHALL COORDINATE WORK FOR THE VARIOUS TRADES INCLUDING PANDA EXPRESS'S VENDORS.

13. TEMPORARY FACILITIES

PROVIDE AND COMPLETE ALL PRELIMINARY WORK AND TEMPORARY CONSTRUCTION REQUIRED AS INDICATED AND REQUIRED.

TEMPORARY BARRICADES: INSTALL TEMPORARY BARRICADE AS REQUIRED BY CITY OFFICIALS OR MALL MANAGEMENT IN MANNER STIPULATED BY SAME.

LIGHT AND POWER SHALL BE PROVIDED BY ELECTRICAL CONTRACTOR OR REUSE EXISTING FROM LOCATION OF LANDLORD'S SERVICE AND PAY ALL COST FOR SAME, FOR ALL CONTRACTOR(S) TO SUBJECT SPACE.

WATER SUPPLY: THE CONTRACTOR SHALL MAKE ALL NECESSARY ARRANGEMENTS FOR PERMANENT WATER SERVICE, WATER METER, AND PRESSURE REGULATOR FOR ALL PURPOSES OF CONSTRUCTION, PAYING ALL COSTS IN CONNECTION WITH SAME, AND FOR ALL WATER USED. THIS SHALL INCLUDE ALL MEANS OF CONVEYING SAME TO PLACE WHERE REQUIRED.

ELECTRICITY: THE CONTRACTOR SHALL MAKE ALL NECESSARY APPLICATIONS, PAY ALL DUES AND CHARGES, OBTAIN NECESSARY PERMITS, PROVIDE AND MAINTAIN ELECTRICAL ENERGY FROM DEVELOPERS PERMANENT ELECTRICAL FACILITIES FOR LIGHTING, POWER FOR ALL ELECTRIC TOOLS AND EQUIPMENT REQUIRED IN CONSTRUCTION OF ALL BRANCHES OF THE WORK AND PAY FOR ALL CURRENT USED.

FIRE PROTECTION: OWNER'S CONTRACTOR SHALL PROVIDE FIRE EXTINGUISHERS WITHIN THE PREMISES AS REQUIRED BY CODE AND/OR INSURANCE COMPANIES, OR VERIFY THAT ONE IS EXISTING IN THE CASE OF REMODELING. DISCONNECT AND SEAL UTILITIES SERVING STRUCTURE TO BE DEMOLISHED, PRIOR TO START OF DEMOLITION WORK.

14. STRICTLY PROHIBITED WORK AND PRACTICES

INSTALLATION OF ANY COMBUSTIBLE MATERIALS ABOVE FINISHED CEILINGS OR IN ANY OTHER CONCEALED, NON-SPRINKLERED SPACE.

IMPOSING ANY STRUCTURAL LOAD, TEMPORARY OR PERMANENT, ON ANY PART OF THE WORK OR STRUCTURE WITHOUT APPROVAL.

ATTACHING ANY WORK TO METAL DECK OR HANGING FROM PLUMBING AND SPRINKLER PIPING OR CONDUIT.

15. POLLUTION CONTROLS

USE WATER SPRINKLING, TEMPORARY ENCLOSURES, AND OTHER SUITABLE METHODS TO LIMIT DUST AND DIRT RISING AND SCATTERED IN AIR TO LOWEST PRACTICAL LEVEL. COMPLY WITH GOVERNING REGULATIONS PERTAINING TO ENVIRONMENTAL PROTECTION. DO NOT USE WATER WHEN IT MAY CREATE HAZARDOUS OR OBJECTIONABLE CONDITIONS SUCH AS ICE, FLOODING AND POLLUTION.

CLEAN ADJACENT STRUCTURES AND IMPROVEMENTS OF DUST, DIRT AND DEBRIS CAUSED BY DEMOLITION OPERATIONS, AS DIRECTED BY ARCHITECT OR GOVERNING AUTHORITIES. RETURN ADJACENT AREAS TO CONDITION EXISTING PRIOR TO START OF WORK.

16. TURNOVER REQUIREMENTS

1. THE CONTRACTOR SHALL ARRANGE FOR ALL INSPECTIONS AND FURNISH OWNERS REPRESENTATIVE WITH THE CERTIFICATE OF OCCUPANCY. G.C. IS ALSO TO PROVIDE A TYPEWRITTEN LIST OF NAMES, ADDRESSES AND PHONE NUMBERS OF ALL SUB-CONTRACTORS AND MATERIAL SUPPLIERS.

2. THE CONTRACTOR SHALL BE RESPONSIBLE FOR HAVING THE ENTIRE STORE CLEAN AND SPOTLESS AT THE TIME OF FURNITURE INSTALLATION AND AT TURN OVER.

3. PRIOR TO THE STORE OPENING, CONTRACTOR IS TO ARRANGE FOR AN INDEPENDENT BALANCING CONTRACTOR, BALANCE THE HVAC SYSTEM AND PROVIDE A COPY OF THE BALANCING REPORT TO OWNER'S REPRESENTATIVE.

4. CONTRACTOR TO TURN OVER ALL KEYS TO THE OWNER'S REPRESENTATIVE AND MARKING EACH KEY FOR IDENTIFICATION. THE CONTRACTOR SHALL SET ALL TIME CLOCKS, THERMOSTATS, ETC. PER OWNER'S REPRESENTATIVE'S REQUIREMENTS.

5. THE CONTRACTOR SHALL EXPLAIN THE OPERATION OF ALL MECHANICAL SYSTEMS TO THE OWNER'S REPRESENTATIVE AND PROVIDING COPIES OF OPERATION, MAINTENANCE AND WARRANTY MANUALS.

DIVISION 2 - SITE WORK

NOT USED

DIVISION 3 - CONCRETE

NOT USED

DIVISION 4 - MASONRY

NOT USED

DIVISION 5 - METALS

1. STEEL FRAMING

REFERENCE STRUCTURAL DRAWINGS FOR STEEL FRAMING SPECIFICATIONS

2. MISCELLANEOUS METALS

CUSTOM FABRICATE FERROUS METAL ITEMS 16 GAUGE AND HEAVIER. REFER TO DRAWINGS AND DETAILS.

3. METAL STUDS

INSTALL METAL FRAMING SYSTEMS IN ACCORDANCE WITH MANUFACTURER'S PRINTED OR WRITTEN INSTRUCTIONS AND RECOMMENDATIONS, UNLESS OTHERWISE INDICATED. INSTALL CONTINUOUS TRACK - SIZED TO MATCH STUDS. SECURE TRACKS AS RECOMMENDED BY STUD MANUFACTURER FOR TYPE OF CONSTRUCTION INVOLVED.

SET STUDS PLUMB, EXCEPT AS NEEDED FOR DIAGONAL BRACING OR REQUIRED FOR NON-PLUMB WALLS OR WARPED SURFACES.

INSTALL SUPPLEMENTARY FRAMING, BLOCKING AND BRACING IN METAL FRAMING SYSTEM WHENEVER WALL OR PARTITIONS ARE INDICATED TO SUPPORT FIXTURES, EQUIPMENT, SERVICES, CASEWORK, HEAVY TRIM AND FURNISHINGS AND SIMILAR WORK.

SECURE STUDS TO TOP AND BOTTOM RUNNER TRACKS BY EITHER WELDING OR SCREW FASTENING AT BOTH INSIDE AND OUTSIDE FLANGES.

INSTALL HORIZONTAL STIFFENERS IN STUD SYSTEM AS REQUIRED, SPACE (VERTICAL DISTANCE) AT NO MORE THAN 4'-6" O.C.

4. EXTERIOR ALUMINUM AWNINGS

DIVISION 6 - WOOD AND PLASTICS

1. WOOD FRAME AND ROOF TRUSSES

REFERENCE STRUCTURAL DRAWINGS FOR SPECIFICATIONS OF WOOD FRAMING AND TRUSSES

2. FINISH CARPENTRY MATERIALS

QUALITY ASSURANCE: PERFORM FINISH CARPENTRY WORK IN ACCORDANCE WITH AIA QUALITY STANDARDS, PREMIUM GRADE. USE FULL LENGTH PIECES, MITER ALL JOINTS, SHOULDER JOINT AT DOOR JAMBS. FILL ALL NAIL HOLES AND SAND SMOOTH.

WOOD TRIM INTERIOR: VERTICAL GRAIN, RED OAK SURFACE ALL EXPOSED EDGES.

EXPOSED WOOD AT EXTERIOR: RESAWN DOUGLAS FIR, NO KNOTS, STAIN GRADE.

DIVISION 7 - THERMAL AND MOISTURE PROTECTION

NOT USED

DIVISION 8 - DOORS AND WINDOWS

NOT USED

DIVISION 9 - FINISHES

1. GYPSUM WALLBOARD

PROVIDE ALL WORK IN ACCORDANCE WITH MANUFACTURER'S DIRECTIONS AS REQUIRED HEREIN AND AS SHOWN ON THE DRAWINGS FOR COMPLETE ERECTION AND FINISH OF DRYWALL PARTITIONS.

COMPLY WITH "GYPSUM CONSTRUCTION AND HANDBOOK" BY UNITED STATES GYPSUM CO. AND "RECOMMENDED SPECIFICATIONS FOR THE APPLICATION AND FINISHING OF GYPSUM BOARD" BY THE GYPSUM ASSOCIATION FOR ALL INSTALLATION WORK.

FIRE-RATED GYPSUM WALLBOARD, ASTM C3078, USE 4 FEET WIDE SHEETS WITH LONG TAPERED EDGE, THICKNESS SHALL BE 5/8" UNUNITED STATES GYPSUM CO. SHEET ROCK WIR FIRE CODE "C" FOR FIRE RATED PANELS, SEAL ALL EXPOSED AND CUT EDGES PER MANUFACTURERS RECOMMENDATIONS.

USE 5/8" MOISTURE RESISTANT GYPSUM BOARD IN AREAS SPECIFIED ON THE PLANS AND AT ALL TILE WORK WITHIN 48" OF WET AREAS. EACH SHEET SHALL BE MARKED BY THE MANUFACTURER INDICATING THE MOISTURE RESISTANT CAPABILITIES OF THE PRODUCT.

INSTALL GYPSUM WALLBOARD WITH LONG DIMENSION PERPENDICULAR TO FRAMING.

INSTALL PER MANUFACTURER'S WRITTEN INSTRUCTIONS.

METAL STUDS-CHANNEL-TYPE, ROLL FORM 25 GAUGE MIN (UNLESS NOTED OTHERWISE), SIZE AS NOTED ON DRAWINGS.

CARRYING CHANNELS AND HANGING WIRE - 1-1/2" DEPT, 475 LBS PER 1,000 FEET, MINIMUM 8 GAUGE HANGING WIRE AT 48" O.C. EACH WAY.

FURRING CHANNELS - 7/8" HAT SHAPED.

FASTENING: NAILS-NO. 19 GAUGE, 1-3/8" LONG, 3/16" HEAD ANNULAR RING NAIL, 7" ON CENTER AT CEILING, 8" ON CENTER AT WALLS.

SCREWS - METAL SUSPENSION, SYSTEM, TYPE "S-12" BUGLE, SELF-TAPPING, 3/8" MINIMUM PENETRATION IN METAL FRAMING.

METAL EDGES SHALL BE APPLIED AT ALL EXPOSED CORNERS, ENDS, ETC.

ACCESS PANELS: 18"X20"X1/8", (414) 383-4030, TYPE "M" WITH FLUSH SCREW DRIVE OPERATED LOCKS IN GYPSUM DRYWALL AND CEILINGS USE PRIME COATED STEEL, IN TILE FINISH WALL AND "FRP" FINISH WALLS USE STAINLESS STEEL, FRAMES AND PANELS.

2. CERAMIC TILE

STANDARDS: MORTAR AND GROUT MATERIALS AND INSTALLATION STANDARDS OF THE AMERICAN NATIONAL STANDARDS INSTITUTE (ANSI) AND STANDARD SPECIFICATION FOR CERAMIC TILE (ANSI A137.1 APPLY TO THE WORK, EXCEPT AS OTHERWISE INDICATED.

MATERIALS: REFERENCE TILE SCHEDULE

TRIM SHAPES: SAME MATERIAL, SIZE, COLOR AND TEXTURE AS FIELD TILE UNLESS NOTED OTHERWISE.

EDGE STRIPS: PROVIDE AT EXPOSED EDGE OF TILE MEETING CARPET, WOOD OR RESILIENT FLOORING UNLESS NOTED OTHERWISE REFERENCE DRAWINGS FOR SIZE AND SHAPE.

CLEANING AND PROTECTION: CLEAN TILE IN ACCORDANCE WITH APPLICABLE ANSI STANDARDS FOR TYPE OF TILE AND METHOD OF INSTALLATION USED AND MANUFACTURER'S INSTRUCTIONS. APPLY HEAVY KRAFT PAPER OR OTHER HEAVY PROTECTIVE COVERING TO PREVENT SURFACE DAMAGE.

3. LAY-IN CEILING TILE

PROVIDE ALL LABOR, MATERIALS, EQUIPMENT, ETC., REQUIRED TO SUPPLY AND INSTALL ARMSTRONG LAY-IN TILE AND CHICAGO METALLIC SUSPENSION SYSTEM, INCLUDING WIRE HANGERS, MAIN TEE RUNNERS, CROSS TEES, ANGLE MOLDING AND HOLD-DOWN CLIP WHERE REQUIRED. SEE REFLECTED CEILING PLAN AND COLOR LEGEND FOR MANUFACTURER AND TYPE.

SUSPENSION SYSTEM: 01. MAIN TEE RUNNERS SHALL BE INSTALLED AT 48" O.C. HAVING CROSS TEES AT 24" O.C. INCLUDING #425 ACCESSIBLE HOLD-DOWN CLIPS AND PERIMETER WALL MOLDING AT ALL VERTICAL ABUTTING SURFACES.

CONTRACTOR TO PROVIDE 1 CARTON, TEN (10) PICES MINIMUM AT JOB SITE TO OWNERS REPRESENTATIVE FOR FUTURE MAINTENANCE.

COMPLY WITH MANUFACTURER'S INSTRUCTIONS AND RECOMMENDATIONS.

PAINTING: WORK INCLUDES SURFACES PREPARATION AND PAINTING OR FINISHING OF ALL INTERIOR SURFACES EXPOSED TO VIEW, THROUGHOUT THE PROJECT. WHERE ITEMS OR SURFACES ARE NOT SPECIFICALLY MENTIONED, PAINT THE SAME AS SIMILAR ADJACENT MATERIALS OR AREAS. THE WORK OF THIS SECTION INCLUDES, BUT IS NOT NECESSARILY LIMITED TO PAINTING OR FINISHING OF ALL INTERIOR DRYWALL SURFACES NOT FINISHED OTHERWISE.

A. MATERIALS: PROVIDE PRODUCTS EQUAL TO MATERIALS LISTED IN THE FINISH SCHEDULE. NOTE THAT PROPRIETARY NAMES USED TO DESIGNATE COLORS (ON THE DRAWINGS) OR MATERIALS (SCHEDULED HEREIN) ARE NOT INTENDED TO IMPLY THAT PRODUCTS OF NAMED MANUFACTURER ARE REQUIRED TO EXCLUSION OF EQUIVALENT PRODUCTS OF OTHER MANUFACTURERS. PRIOR APPROVAL OF OWNERS REPRESENTATIVE REQUIRED.

B. SURFACE PREPARATION: CLEAN SURFACES OF DIRT, RUST SCALE, GREASE, MOISTURE OR OTHER CONDITIONS OTHERWISE DETRIMENTAL TO FORMATION OF A DURABLE PAINT FILM. PERFORM PREPARATION AND CLEANING PROCEDURES IN ACCORDANCE WITH PAINT MANUFACTURER'S PRINTED INSTRUCTIONS FOR EACH PARTICULAR SUBSTRATE CONDITION.

GALVANIZED METAL: CLEAN ALL SURFACES THOROUGHLY WITH SOLVENT UNTIL THEY ARE COMPLETELY FREE FROM DIRT, OIL AND GREASE. ALLOW TO DRY THOROUGHLY BEFORE APPLICATION OF PAINT.

REMOVE HARDWARE, ACCESSORIES, PLATES, LIGHTING FIXTURES, AND SIMILAR ITEMS IN PLACE AND NOT TO BE FINISH PAINTED, OR PROVIDE SURFACED APPLIED PROTECTION PRIOR TO SURFACE PREPARATION AND PAINTING OPERATIONS. REMOVE, IF NECESSARY, FOR COMPLETION OF PAINTING OF EACH SPACE OR AREA, REINSTALL REMOVED ITEMS.

C. APPLICATION: GENERAL: THE FINISHED SURFACE SHALL BE FREE FROM RUNS, SAGS, DROPS, RIDGES, WEAVES, LAPS, BRUSH MARKS AND VARIATIONS IN COLOR, TEXTURE AND FINISH.

COATING PROCESS: SUFFICIENT TIME SHALL ELAPSE BETWEEN SUCCESSIVE COATS TO PERMIT PROPER DRYING.

MIXING AND THINNING: AT TIME OF APPLICATION, PAINT SHALL SHOW NO SIGNS OF HARD SETTLING, EXCESSIVE SKINNING, LIVERING OR OTHER DETERIORATION. PAINT SHALL BE THOROUGHLY STIRRED, STRAINED AND KEPT AT A UNIFORM CONSISTENCY DURING APPLICATION.

STORAGE: THE PAINTER SHALL STORE ALL MATERIALS AND EQUIPMENT IN A ROOM ASSIGNED FOR THAT PURPOSE. PRECAUTIONS SHALL BE TAKEN TO REDUCE FIRE HAZARD AND THE ROOM SHALL BE KEPT CLEAN AND IN GOOD CONDITION.

CLEAN UP: SCHEDULE ALL CLEANING AND PAINTING SO THAT DUST AND OTHER CONTAMINANTS FROM THE CLEANING PROCESS WILL NOT FALL ON WET, NEWLY PAINTED SURFACES. DURING THE PROGRESS OF THE WORK, DO NOT ALLOW THE ACCUMULATION OF EMPTY CONTAINERS OR OTHER EXCESS ITEMS. REMOVE FROM SITE DISCARDED PAINT MATERIALS, RUBBISH, CANS AND TRAYS AT END OF EACH WORK DAY. UPON COMPLETION OF PAINTING WORK, CLEAN WINDOW GLASS AND OTHER PAINT SPATTERED SURFACES. REMOVE SPATTERED PAINT AND REPAIR DEFACED PAINTED SURFACES AFTER COMPLETION OF WORK OF OTHER TRADES. IF OWNER DEEMS CLEAN-UP IS NOT SATISFACTORY, AND INDEPENDENT CLEANING SERVICE WILL BE BROUGHT IN, AT THE CONTRACTOR'S EXPENSE TO COMPLETE THE CLEAN-UP.

CONTRACTOR SHALL PROVIDE ONE (1) QUART OF UNCOVERED PAINT, STAIN AND SEALER OF EACH COLOR AND TYPE USED IN LABELED, COVERED CANS FOR THE OWNER. PLACE IN CARTONS FOR STORAGE.

SEE PAINT SCHEDULE, SHEET G-005. FINAL FINISH IS SUBJECT TO APPROVAL BY OWNER. IF FINISH IS DEEMED UNSATISFACTORY, ANOTHER APPLICATION WILL BE REQUIRED AT THE CONTRACTOR'S EXPENSE. PROVIDE PAINT AND COATINGS AS LISTED BELOW:

5. EXTERIOR PAINTING

A. METAL
ONE COAT PRIMER
TWO COATS PER SCHEDULE
(NOTE: PRIMER MAY BE ELIMINATED IF ITEM IS FACTORY PRIMED)

B. CEMENT PLASTER:
ONE COAT PRIMER
TWO COATS PER SCHEDULE

C. CONCRETE MASONRY (EXPOSED):
ONE COAT SEALER
TWO COATS MASONRY PAINT PER SCHEDULE

D. SAW-TEXTURED WOOD SURFACE:
ONE COAT STAIN PER SCHEDULE

E. TRASH ENCLOSURE (INSIDE)
ONE COAT CONCRETE BLOCK FILLER
TWO COATS VINYL-ACRYLIC PAINT, COLOR TO MATCH BUILDING

6. INTERIOR PAINTING

A. METAL
ONE COAT PRIMER
TWO COATS PER SCHEDULE
(NOTE: PRIMER MAY BE ELIMINATED IF ITEM IS FACTORY PRIMED)

B. WOOD DOORS (PAINTED):
ONE COAT INTERIOR TRIM PRIMER
TWO COATS PER SCHEDULE

C. SMOOTH FINISH GYPSUM BOARD WALL AND CEILINGS
(GLOSS OR EGGSHELL):
ONE COAT WALL PRIMER
TWO COATS PER SCHEDULE

D. OAK TRIM (SMOOTH WOOD) "LAQUERED"
ONE COAT LAQUER SANDING SEALER
TWO COATS SEMI-GLOSS LAQUER

E. INSIDE THROATS OF AIR CONDITIONING SUPPLY AND RETURN
DUCTS IN PUBLIC AREAS
SPRAY BLACK TO A POINT OUT OF VIEW

7. GENERAL FIN

DIVISION 10 - SPECIALTIES

1. PORTABLE FIRE EXTINGUISHERS

PROVIDE GLASS ABC, 10 LB. DRY CHEMICAL OR AS REQUIRED BY FIRE CODES. MINIMUM ONE FURNISHED BY G.C. AT START OF CONSTRUCTION.

2. WALL VENT

GALVANIZED STEEL FRAME AND 45 DEG. BLADES, INSECT SCREEN, PRIME COATED. SEE DRAWINGS FOR SIZE.

3. SOFFIT VENT

FRY REGLET "CLEAR FINISH EIFS SOFFIT VENT" 3" W X ½"D.

4. TOILET ROOM ACCESSORIES

NOT USED

DIVISION 11 - EQUIPMENT

1. FOOD SERVICE EQUIPMENT

THE GENERAL CONTRACTOR SHALL BE RESPONSIBLE FOR COORDINATION OF THIS WORK AND FOR ASSEMBLIES AND HOOK-UP OF FOOD SERVICE EQUIPMENT PROVIDED BY OTHERS, SUCH AS, BUT NOT LIMITED TO, WALK-IN COOLER, WALK-IN FREEZER AND COMPLETE HOT WELLS SERVICE COUNTER ASSEMBLIES.

2. RELATED WORK DESCRIBED ELSEWHERE

THE GENERAL CONTRACTOR SHALL BE RESPONSIBLE FOR WORK OF SECTION "PLUMBING" INCLUDES SETTING OF FAUCETS AND CONNECTIONS TO SERVICES, INTERCONNECTIONS OF EQUIPMENT, FLOOR DRAINS IN THE VICINITY OF INDIRECT DRAIN OUTLETS, FAUCETS AND TRIM.

THE GENERAL CONTRACTOR SHALL BE RESPONSIBLE FOR ELECTRIC WORK INCLUDES ALL LINE SWITCHES, SAFETY CUT-OUTS, CONTROL PANELS, FUSE BOXES AND OTHER CONTROLS, ELECTRICAL RECEPTACLES, FITTINGS AND CONNECTIONS, EXCEPT AS OTHERWISE SPECIFIED IN SECTION "ELECTRICAL". ELECTRICAL CONTRACTOR SHALL MAKE FINAL CONNECTIONS TO BUILDING FROM ALL JUNCTION BOXES.

3. AS-BUILT DRAWINGS

GENERAL CONTRACTOR SHALL KEEP AN ACCURATE DIMENSIONED RECORD ON REPRODUCIBLE TRANSPARENCIES OF AS-BUILT LOCATIONS, AND OF WORK WHICH IS INSTALLED DIFFERENTLY FROM THAT SHOWN.

4. LOCATIONS AND ACCESSIBILITY

CONTRACTOR SHALL FULLY INFORM HIMSELF REGARDING PECULIARITIES AND LIMITATIONS OF SPACES AVAILABLE FOR INSTALLATION OF WORK AND MATERIALS FURNISHED AND INSTALLED UNDER THIS DIVISION. DRAWINGS INDICATE LOCATION AND ARRANGEMENT OF CONDUIT, EQUIPMENT AND OTHER ITEMS AND ARE TO BE FOLLOWED AS CLOSELY AS POSSIBLE. WORK SPECIFIED AND NOT CLEARLY DEFINED BY DRAWINGS SHALL BE INSTALLED AND ARRANGED IN A MANNER SATISFACTORY TO PANDA PM. IN EVENT CHANGES IN INDICATED LOCATIONS AND ARRANGEMENTS ARE DEEMED NECESSARY BY PANDA PM, THEY SHALL BE MADE BY THE CONTRACTOR WITHOUT ADDITIONAL CHARGES PROVIDED THAT THE CHANGES ARE ORDERED BEFORE THE WORK IS INSTALLED AND NO EXTRA MATERIALS OR LABOR ARE REQUIRED.

5. CLEANING OF EQUIPMENT, MATERIALS AND PREMISES

CLEAN EQUIPMENT AND MATERIALS THOROUGHLY. LEAVE SURFACES TO BE PAINTED SMOOTH AND CLEAN, READY FOR PAINTERS. CLEAN ENTIRE PREMISES OF UNUSED MATERIALS, RUBBISH, DEBRIS AND DIRT CREATED BY WORK UNDER THIS DIVISION.

6. OPERATION AND MAINTENANCE INSTRUCTIONS

FULLY INSTRUCT AND DEMONSTRATE TO THE OWNERS OPERATING PERSONNEL THE PERFORMANCE, OPERATION AND MAINTENANCE OF EQUIPMENT. THE TIME ALLOWED FOR SAID INSTRUCTION SHALL BE ALLOWED FOR EACH CONTRACTOR AS PART OF THESE CONTRACT DOCUMENTS.

7. TESTING AND ADJUSTMENT

UPON COMPLETION OF ELECTRICAL WORK, ADJUST AND TEST CIRCUITS, OUTLETS, SWITCHES, LIGHTS, MOTORS AND TIME CLOCKS TO INSURE PROPER OPERATION OF ELECTRICAL EQUIPMENT. CHECK SERVICE VOLTAGES UNDER MAXIMUM LOAD. ITEMS, FIXTURES AND PARTS IN NEED OF CORRECTION AND DISCOVERED DURING SUCH TESTING SHALL BE IMMEDIATELY REPAIRED OR REPLACED WITH NEW EQUIPMENT, AND THAT PART OF THE SYSTEM SHALL BE RETESTED. SUCH REPLACEMENT OR REPAIR SHALL BE DONE AT NO ADDITIONAL COST TO THE OWNER.

DIVISION 12 - FURNISHINGS

NOT USED

DIVISION 13 -SPECIAL CONSTRUCTION

NOT USED

DIVISION 14 - CONVEYING SYSTEM

NOT USED

DIVISION 15 - MECHANICAL

REFER TO MECHANICAL AND PLUMBING DRAWINGS FOR SPECIFICATIONS

DIVISION 16 - ELECTRICAL

REFER TO ELECTRICAL DRAWINGS FOR ELECTRICAL SPECIFICATIONS

FIRE PREVENTION NOTES

1. ALL WORK SHALL COMPLY WITH THE VERSION OF THE INTERNATIONAL FIRE CODE AS AMENDED AND ADOPTED BY THE LOCAL AGENCIES HAVING AUTHORITY.

2. THE CONTRACTOR SHALL PROVIDE FIRE EXTINGUISHER AS REQUIRED BY LOCAL JURISDICTIONS. COORDINATE EXACT LOCATIONS WITH BASE FIRE MARSHAL REPRESENTATIVE.

3. G.C. TO PROVIDE ONE PORTABLE FIRE EXTINGUISHER WHICH HAS A CLASSIFICATION OF NOT LESS THAN K-TYPE FOR KITCHEN (U.F.C. SEC. 10.303) LOCATION TO BE APPROVED BY THE LOCAL AUTHORITIES PRIOR TO INSTALLATION.

4. PENETRATIONS OF RATED WALLS SHALL BE PROTECTED BY ASSEMBLIES OF APPROPRIATE RATING, INCLUDING DOORS, DUCTS, ETC. ALL REQUIRED FIRE DAMPER ASSEMBLIES INCLUDING SLEEVES AND INSTALLATION PROCEDURES SHALL BE APPROVED BY THE BUILDING DEPARTMENT INSPECTOR PRIOR TO INSTALLATION.

5. WHERE REQUIRED, ALL AIR-HANDLING CUT-OFF AND SMOKE-DETECTED FIRE DAMPING EQUIPMENT REQUIRED BY THE LOCAL AGENCIES HAVING AUTHORITY SHALL BE PROVIDED AND INSTALLED BY THE MECHANICAL CONTRACTOR.

6. WHERE REQUIRED, FLAME SPREAD RATINGS OF MATERIAL USED IN THE CONSTRUCTION WILL BE SUPPLIED TO THE FIRE DEPARTMENT BY THE CONTRACTOR ORDERING THE MATERIALS.

7. ILLUMINATED EXIT SIGNS WITH BATTERY PACKS AND AUDIBLE SIGNALS SHALL BE PROVIDED AS SHOWN ON THE DRAWINGS AND AS REQUIRED BY CODE TO BE INSTALLED BY GC.

8. IF REQUIRED, COORDINATE FIRE SPRINKLER SYSTEM REQUIREMENTS WITH LOCAL AUTHORITIES. INSTALLATION SHALL COMPLY WITH NFPA 13. FIRE SPRINKLER PROTECTION SHALL BE PROVIDED ABOVE AND INSIDE WALK-IN COOLER AND FREEZERS.

9. INTERIOR FINISH SHALL COMPLY WITH ALL APPLICABLE CODES.

10. PROVIDE AN APPROVED AUTOMATIC FIRE EXTINGUISHING SYSTEM IN THE COOKING EXHAUST HOOD.

11. ALL DECORATIVE MATERIALS SHALL BE MAINTAINED IN A FLAME-RETARDANT CONDITION.

12. DUCTS SERVING A COOKING EXHAUST HOOD SHALL BE ENCLOSED IN A FIRE RATED ENCLOSURE (SEE MECHANICAL DRAWINGS FOR REQUIREMENT).

13. BUILDING NUMBERS SHALL BE EASILY VISIBLE AND LEGIBLE FROM THE STREET OR ROAD FRONTING THE PROPERTY.

14. THE CONSTRUCTION, REMODEL, OR DEMOLITION OF A BUILDING SHALL COMPLY WITH ALL APPLICABLE CODES.

15. WHERE REQUIRED, GC TO PROVIDE OCCUPANT LOAD SIGN COMPLYING WITH CODE.

16. WHERE REQUIRED, EXIT DOORS SHALL HAVE PANIC HARDWARE AND SHALL SWING IN THE DIRECTION OF EXIT TRAVEL WHEN SERVING ANY HAZARDOUS AREAS, OR ANY OTHER OCCUPANCY SERVING AN OCCUPANT LOAD OF 50 OR MORE.



PANDA RESTAURANT GROUP INC.

1683 Walnut Grove Ave.
Rosemead, California
91770

Telephone: 626.799.9898
Facsimile: 626.372.8288

All ideas, designs, arrangement and plans indicated or represented by this drawing are the property of Panda Express Inc. and were created for use on this specific project. None of these ideas, designs, arrangements or plans may be used by or disclosed to any person, firm, or corporation without the written permission of Panda Express Inc.

REVISIONS:

| | | |
|--|--|--|
| | | |
| | | |
| | | |
| | | |
| | | |
| | | |
| | | |
| | | |
| | | |
| | | |

ISSUE DATE:

| | | |
|---|---------------|------------|
| 1 | 35% SUBMITTAL | 06/23/2023 |
| 2 | 95% SUBMITTAL | 10/04/2023 |
| 3 | BID SET | 11/10/2023 |

| | |
|--|--|
| | |
| | |
| | |
| | |

DRAWN BY: STAFF

PANDA PROJECT #:

ARCH PROJECT #:



GARY WANG
& ASSOCIATES, INC.

1000 Corporate Center Dr., Ste. 550
Monterey Park, CA 91754
TEL: (626) 288-6898 FAX: (626) 768-7101
http://www.garywang.com



PANDA EXPRESS

BLDG 740 TROOP STORE FOOD COURT
SHEPPARD AFB, TX
76311

G-003

SPECIFICATIONS

BID SET | 11/10/2023 | NOT FOR CONSTRUCTION